



# Greenup Slim Downlight

## DN150B LED6S 840 PSU GM

Greenup Slim Downlight, 6.5 W, 650 lm, 4000 K, Textured, IP20 | Finger-protected

Greenup Slim downlight is ultra-thin product for general lighting applications with limited build-in height, which is suitable for a series of Lighting applications in Office, Retail and General Area Lighting. Available in a wide variety of lumen packs, cut out size, color temp and dimming option (ETO approach).

### Product data

General Information	
Number of gear units	1 unit
Driver included	Yes
Light source engine type	LED
Service tag	Yes
Warranty period	3 years
Light Technical	
Luminous Flux	650 lm
Correlated Color Temperature (Nom)	4000 K
Luminous Efficacy (rated) (Nom)	100 lm/W
Color rendering index (CRI)	>80
Beam angle of light source	- degree(s)
Light source color	840 neutral white
Optic type	-
Luminaire light beam spread	-

Operating and Electrical	
Input Voltage	220 to 240 V
Line Frequency	50 or 60 Hz
Initial CLO power consumption	N.A. W
Average CLO power consumption	N.A. W
Power Consumption	6.5 W
Power Factor (Fraction)	0.9
Connection	Push-in connector 2-pole
Cable	-
Number of products on MCB of 16 A type B	-
Suitable for random switching	No
Protection class IEC	Safety class II
Controls and Dimming	
Dimmable	No
Driver/power unit/transformer	Power supply unit (On/Off)
Control interface	-

# Greenup Slim Downlight

Constant light output	No
Maximum dim level	Not applicable

## Mechanical and Housing

Housing Material	Aluminum
Reflector material	-
Optic material	Polymethyl methacrylate
Optical cover material	Polymethyl methacrylate
Fixation material	Aluminum
Housing Color	White
Optical cover finish	Textured
Overall length	0 mm
Overall width	0 mm
Overall height	30 mm
Overall diameter	85 mm
Dimensions (Height x Width x Depth)	30 x 0 x 0 mm
Ingress protection code	IP20 [Finger-protected]
Mech. impact protection code	IK02 [0.2 J standard]
Optical cover type	Polycarbonate Diffuser
Net Weight (Piece)	0.160 kg

## Approval and Application

Glow-wire test	Temperature 650 °C, duration 30 s
Flammability mark	-
CE mark	Yes
ENEC mark	-

EU RoHS compliant	Yes
Ambient temperature range	-20 to +40 °C

## Initial Performance (IEC Compliant)

Luminous flux tolerance	+/-10%
Initial chromaticity	SDCM<5
Power consumption tolerance	+/-10%

## Over Time Performance (IEC Compliant)

Driver failure rate at 5000 h	0.0015 %
Median useful life L70B50	57,000 hour(s)
Median useful life L80B50	35,000 hour(s)
Median useful life L90B50	16,000 hour(s)

## Product Data

Order product name	DN150B LED6S 840 PSU GM
Full product name	DN150B LED6S 840 PSU GM
Full product code	871016333924599
Order code	911401803080
Material Nr. (12NC)	911401803080
Numerator - Quantity Per Pack	1
EAN/UPC - Product/Case	8710163339245
Numerator - Packs per outer box	10
EAN/UPC - Case	8710163339566

## Dimensional drawing

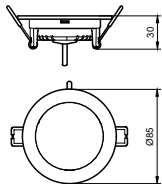

## Greenup Slim Downlight

