



Greenspace Flex

RS378B P42 940 PSU-E WB M102

Greenspace Flex, 42 W, 940 neutral white, 32°, IP20 | Finger-protected

GreenSpace Flex is performance portfolio dedicated to Hospitality segment for GC/GM countries. With modular design concept, the light engines and different trims could have multiply of combination to satisfy diversified customer's requirement.

Product data

General Information		Average CLO power consumption	
Number of gear units	1 unit	Average CLO power consumption	3515 W
Driver included	Yes	Power Consumption	42 W
Light source engine type	LED	Power Factor (Fraction)	0.9
Value ladder	Performance	Connection	External connector
Warranty period	3 years	Cable	-
Light Technical		Number of products on MCB of 16 A type B	-
Luminous Flux	2,400 lm	Suitable for random switching	No
Correlated Color Temperature (Nom)	4000 K	Protection class IEC	Safety class II
Luminous Efficacy (rated) (Nom)	73 lm/W	Controls and Dimming	
Color rendering index (CRI)	>90	Dimmable	No
Beam angle of light source	- degree(s)	Driver/power unit/transformer	Electronic transformer
Light source color	940 neutral white	Control interface	-
Optic type	-	Constant light output	No
Luminaire light beam spread	32°	Maximum dim level	Not applicable
Operating and Electrical		Mechanical and Housing	
Input Voltage	220-240 V	Housing Material	Aluminum Alloy
Line Frequency	50 or 60 Hz	Reflector material	-
		Optic material	Polymethyl methacrylate

Greenspace Flex

Optical cover material	Polymethyl methacrylate
Fixation material	Aluminum
Housing Color	Grey
Optical cover finish	Opal
Overall height	116 mm
Overall diameter	102 mm
Ingress protection code	IP20 [Finger-protected]
Mech. impact protection code	IK04 [0.5 J standard plus]
Optical cover type	PMMA
Net Weight (Piece)	0.940 kg

Approval and Application

Glow-wire test	Temperature 600 °C, duration 30 s
Flammability mark	-
CE mark	Yes
ENEC mark	-
EU RoHS compliant	Yes
Ambient temperature range	-20 to +45 °C

Initial Performance (IEC Compliant)

Luminous flux tolerance	-10% / +10%
Initial chromaticity	SDCM<3
Power consumption tolerance	+/-10%

Over Time Performance (IEC Compliant)

Median useful life L80B50	50.000 hour(s)
---------------------------	----------------

Product Data

Order product name	RS378B P42 940 PSU-E WB M102
Full product name	RS378B P42 940 PSU-E WB M102
Full product code	911401721692
Order code	911401721692
Material Nr. (12NC)	911401721692
Numerator - Quantity Per Pack	1
Numerator - Packs per outer box	12

Dimensional drawing

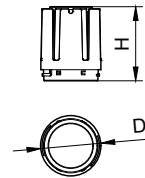
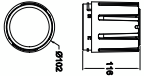

Modular Type	D, mm	H, mm
RS378B P6/P11 M55	55	49
RS378B P15 M55	55	49
RS378B P24 M70	70	90
RS378B P33 M87	87	107
RS378B P42 M102	102	116

