



# Greenspace Flex

## RS378B P42 940 PSU-E WB M102

Greenspace Flex, 42 W, 940 neutral white, 32°, IP20 | Finger-protected

GreenSpace Flex is performance portfolio dedicated to Hospitality segment for GC/GM countries. With modular design concept, the light engines and different trims could have multiply of combination to satisfy diversified customer's requirement.

### Product data

| General Information                |                   |
|------------------------------------|-------------------|
| Number of gear units               | 1 unit            |
| Driver included                    | Yes               |
| Light source engine type           | LED               |
| Value ladder                       | Performance       |
| Warranty period                    | 3 years           |
| Light Technical                    |                   |
| Luminous Flux                      | 2,400 lm          |
| Correlated Color Temperature (Nom) | 4000 K            |
| Luminous Efficacy (rated) (Nom)    | 73 lm/W           |
| Color rendering index (CRI)        | >90               |
| Beam angle of light source         | - degree(s)       |
| Light source color                 | 940 neutral white |
| Optic type                         | -                 |
| Luminaire light beam spread        | 32°               |
| Operating and Electrical           |                   |
| Input Voltage                      | 220-240 V         |
| Line Frequency                     | 50 or 60 Hz       |

| Average CLO power consumption            | 3515 W                  |
|--|-------------------------|
| Power Consumption                        | 42 W                    |
| Power Factor (Fraction)                  | 0.9                     |
| Connection                               | External connector      |
| Cable                                    | -                       |
| Number of products on MCB of 16 A type B | -                       |
| Suitable for random switching            | No                      |
| Protection class IEC                     | Safety class II         |
| Controls and Dimming                     |                         |
| Dimmable                                 | No                      |
| Driver/power unit/transformer            | Electronic transformer  |
| Control interface                        | -                       |
| Constant light output                    | No                      |
| Maximum dim level                        | Not applicable          |
| Mechanical and Housing                   |                         |
| Housing Material                         | Aluminum Alloy          |
| Reflector material                       | -                       |
| Optic material                           | Polymethyl methacrylate |

## Greenspace Flex

|                              |                            |
|------------------------------|----------------------------|
| Optical cover material       | Polymethyl methacrylate    |
| Fixation material            | Aluminum                   |
| Housing Color                | Grey                       |
| Optical cover finish         | Opal                       |
| Overall height               | 116 mm                     |
| Overall diameter             | 102 mm                     |
| Ingress protection code      | IP20 [Finger-protected]    |
| Mech. impact protection code | IK04 [0.5 J standard plus] |
| Optical cover type           | PMMA                       |
| Net Weight (Piece)           | 0.940 kg                   |

### Approval and Application

|                           |                                   |
|---------------------------|-----------------------------------|
| Glow-wire test            | Temperature 600 °C, duration 30 s |
| Flammability mark         | -                                 |
| CE mark                   | Yes                               |
| ENEC mark                 | -                                 |
| EU RoHS compliant         | Yes                               |
| Ambient temperature range | -20 to +45 °C                     |

### Initial Performance (IEC Compliant)

|                             |             |
|-----------------------------|-------------|
| Luminous flux tolerance     | -10% / +10% |
| Initial chromaticity        | SDCM<3      |
| Power consumption tolerance | +/-10%      |

### Over Time Performance (IEC Compliant)

|                           |                |
|---------------------------|----------------|
| Median useful life L80B50 | 50.000 hour(s) |
|---------------------------|----------------|

### Product Data

|                                 |                              |
|---------------------------------|------------------------------|
| Order product name              | RS378B P42 940 PSU-E WB M102 |
| Full product name               | RS378B P42 940 PSU-E WB M102 |
| Full product code               | 911401721692                 |
| Order code                      | 911401721692                 |
| Material Nr. (12NC)             | 911401721692                 |
| Numerator - Quantity Per Pack   | 1                            |
| Numerator - Packs per outer box | 12                           |

## Dimensional drawing

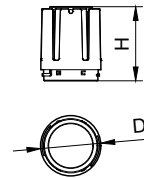
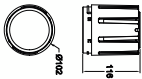

| Modular Type      | D, mm | H, mm |
|-------------------|-------|-------|
| RS378B P6/P11 M55 | 55    | 49    |
| RS378B P15 M55    | 55    | 49    |
| RS378B P24 M70    | 70    | 90    |
| RS378B P33 M87    | 87    | 107   |
| RS378B P42 M102   | 102   | 116   |

