



Greenspace Flex

RS378B P33 940 PSU-E WB M87

Greenspace Flex, 33 W, 940 neutral white, 40°, IP20 | Finger-protected

GreenSpace Flex is performance portfolio dedicated to Hospitality segment for GC/GM countries. With modular design concept, the light engines and different trims could have multiply of combination to satisfy diversified customer's requirement.

Product data

General Information		Power Factor (Fraction)	
Number of gear units	1 unit		0.9
Driver included	Yes	Connection	External connector
Light source engine type	LED	Cable	-
Value ladder	Performance	Number of products on MCB of 16 A type B	-
Warranty period	3 years	Suitable for random switching	No
		Protection class IEC	Safety class II
Light Technical		Controls and Dimming	
Luminous Flux	2,400 lm	Dimmable	No
Correlated Color Temperature (Nom)	4000 K	Driver/power unit/transformer	Electronic transformer
Luminous Efficacy (rated) (Nom)	100 lm/W	Control interface	-
Color rendering index (CRI)	>90	Constant light output	No
Light source color	940 neutral white	Maximum dim level	Not applicable
Luminaire light beam spread	40°		
Operating and Electrical		Mechanical and Housing	
Input Voltage	220-240 V	Housing Material	Aluminum Alloy
Line Frequency	50 or 60 Hz	Optic material	Polymethyl methacrylate
Average CLO power consumption	2635 W	Optical cover material	Polymethyl methacrylate
Power Consumption	33 W	Fixation material	Aluminum
		Housing Color	Grey

Greenspace Flex

Optical cover finish	Opal
Overall height	107 mm
Overall diameter	87 mm
Ingress protection code	IP20 [Finger-protected]
Mech. impact protection code	IK04 [0.5 J standard plus]
Optical cover type	PMMA
Net Weight (Piece)	0.730 kg

Approval and Application

Glow-wire test	Temperature 600 °C, duration 30 s
CE mark	Yes
EU RoHS compliant	Yes
Ambient temperature range	-20 to +45 °C

Initial Performance (IEC Compliant)

Luminous flux tolerance	-10% / +10%
Initial chromaticity	SDCM<3

Power consumption tolerance	+/-10%
-----------------------------	--------

Over Time Performance (IEC Compliant)

Median useful life L80B50	50,000 hour(s)
---------------------------	----------------

Product Data

Order product name	RS378B P33 940 PSU-E WB M87
Full product name	RS378B P33 940 PSU-E WB M87
Full product code	692382865031599
Order code	911401721602
Material Nr. (12NC)	911401721602
Numerator - Quantity Per Pack	1
EAN/UPC - Product/Case	6923828650315
Numerator - Packs per outer box	18
EAN/UPC - Case	6923828652722

Dimensional drawing

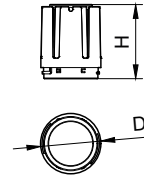
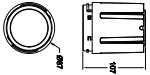

Modular Type	D, mm	H, mm
RS378B P6/P11 M55	55	49
RS378B P15 M55	55	49
RS378B P24 M70	70	90
RS378B P33 M87	87	107
RS378B P42 M102	102	116

