



# GreenSpace Flex

## RS378B P15 940 PSR-E WB M55

GreenSpace Flex, 15 W, 940 neutral white, 40°, Phase-cut dim, IP20 | Finger-protected

GreenSpace Flex is performance portfolio dedicated to Hospitality segment for GC/GM countries. With modular design concept, the light engines and different trims could have multiply of combination to satisfy diversified customer's requirement.

### Product data

General Information		Power Factor (Fraction)	
Number of gear units	1 unit		0.9
Driver included	Yes	Connection	External connector
Light source engine type	LED	Cable	-
Value ladder	Performance	Number of products on MCB of 16 A type B	-
Warranty period	3 years	Suitable for random switching	No
		Protection class IEC	Safety class II
Light Technical		Controls and Dimming	
Luminous Flux	1,410 lm	Dimmable	TRIAC
Correlated Color Temperature (Nom)	4000 K	Driver/power unit/transformer	Electronic transformer
Luminous Efficacy (rated) (Nom)	94 lm/W	Control interface	Phase-cut dim
Color rendering index (CRI)	>90	Constant light output	No
Light source color	940 neutral white	Maximum dim level	10%
Luminaire light beam spread	40°		
Operating and Electrical		Mechanical and Housing	
Input Voltage	220-240 V	Housing Material	Aluminum Alloy
Line Frequency	50 or 60 Hz	Optic material	Polymethyl methacrylate
Average CLO power consumption	845 W	Optical cover material	Polymethyl methacrylate
Power Consumption	15 W	Fixation material	Aluminum
		Housing Color	Grey

## Greenspace Flex

Optical cover finish	Opal
Overall length	0 mm
Overall width	0 mm
Overall height	72 mm
Overall diameter	55 mm
Dimensions (Height x Width x Depth)	72 x 0 x 0 mm
Ingress protection code	IP20 [Finger-protected]
Mech. impact protection code	IK04 [0.5 J standard plus]
Optical cover type	PMMA
Net Weight (Piece)	0.290 kg

### Approval and Application

Glow-wire test	Temperature 600 °C, duration 30 s
CE mark	Yes
EU RoHS compliant	Yes
Ambient temperature range	-20 to +45 °C

### Initial Performance (IEC Compliant)

Luminous flux tolerance	-10% / +10%
-------------------------	-------------

Initial chromaticity	SDCM<3
Power consumption tolerance	+/-10%

### Over Time Performance (IEC Compliant)

Median useful life L80B50	50,000 hour(s)
---------------------------	----------------

### Product Data

Order product name	RS378B P15 940 PSR-E WB M55
Full product name	RS378B P15 940 PSR-E WB M55
Full product code	692382865076699
Order code	911401721422
Material Nr. (12NC)	911401721422
Numerator - Quantity Per Pack	1
EAN/UPC - Product/Case	6923828650766
Numerator - Packs per outer box	48
EAN/UPC - Case	6923828653170

## Dimensional drawing

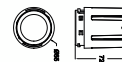
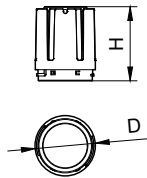

Modular Type	D, mm	H, mm
RS378B P6/P11 M55	55	49
RS378B P15 M55	55	49
RS378B P24 M70	70	90
RS378B P33 M87	87	107
RS378B P42 M102	102	116

