



Greenspace Flex

RS378B P6 930 PSU-E WB M55

Greenspace Flex, 6 W, 930 warm white, 32°, IP20 | Finger-protected

GreenSpace Flex is performance portfolio dedicated to Hospitality segment for GC/GM countries. With modular design concept, the light engines and different trims could have multiply of combination to satisfy diversified customer's requirement.

Product data

| General Information | |
|------------------------------------|----------------|
| Number of gear units | 1 unit |
| Driver included | Yes |
| Light source engine type | LED |
| Value ladder | Performance |
| Warranty period | 3 years |
| Light Technical | |
| Luminous Flux | 1,500 lm |
| Correlated Color Temperature (Nom) | 3000 K |
| Luminous Efficacy (rated) (Nom) | 100 lm/W |
| Color rendering index (CRI) | >90 |
| Beam angle of light source | - degree(s) |
| Light source color | 930 warm white |
| Optic type | - |
| Luminaire light beam spread | 32° |
| Operating and Electrical | |
| Input Voltage | 220-240 V |
| Line Frequency | 50 or 60 Hz |

| Average CLO power consumption | 390 W |
|--|-------------------------|
| Power Consumption | 6 W |
| Power Factor (Fraction) | 0.9 |
| Connection | External connector |
| Cable | - |
| Number of products on MCB of 16 A type B | - |
| Suitable for random switching | No |
| Protection class IEC | Safety class II |
| Controls and Dimming | |
| Dimmable | No |
| Driver/power unit/transformer | Electronic transformer |
| Control interface | - |
| Constant light output | No |
| Maximum dim level | Not applicable |
| Mechanical and Housing | |
| Housing Material | Aluminum Alloy |
| Reflector material | - |
| Optic material | Polymethyl methacrylate |

Greenspace Flex

| | |
|------------------------------|----------------------------|
| Optical cover material | Polymethyl methacrylate |
| Fixation material | Aluminum |
| Housing Color | Grey |
| Optical cover finish | Opal |
| Overall height | 49 mm |
| Overall diameter | 55 mm |
| Ingress protection code | IP20 [Finger-protected] |
| Mech. impact protection code | IK04 [0.5 J standard plus] |
| Optical cover type | PMMA |
| Net Weight (Piece) | 0.170 kg |

Approval and Application

| | |
|---------------------------|-----------------------------------|
| Glow-wire test | Temperature 600 °C, duration 30 s |
| Flammability mark | - |
| CE mark | Yes |
| ENEC mark | - |
| EU RoHS compliant | Yes |
| Ambient temperature range | -20 to +45 °C |

Initial Performance (IEC Compliant)

| | |
|-------------------------|-------------|
| Luminous flux tolerance | -10% / +10% |
|-------------------------|-------------|

| | |
|-----------------------------|--------|
| Initial chromaticity | SDCM<3 |
| Power consumption tolerance | +/-10% |

Over Time Performance (IEC Compliant)

| | |
|---------------------------|----------------|
| Median useful life L80B50 | 50,000 hour(s) |
|---------------------------|----------------|

Product Data

| | |
|---------------------------------|----------------------------|
| Order product name | RS378B P6 930 PSU-E WB M55 |
| Full product name | RS378B P6 930 PSU-E WB M55 |
| Full product code | 692382864992099 |
| Order code | 911401720962 |
| Material Nr. (12NC) | 911401720962 |
| Numerator - Quantity Per Pack | 1 |
| EAN/UPC - Product/Case | 6923828649920 |
| Numerator - Packs per outer box | 48 |
| EAN/UPC - Case | 6923828652333 |

Dimensional drawing

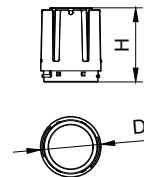
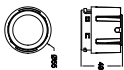

| Modular Type | D, mm | H, mm |
|-------------------|-------|-------|
| RS378B P6/P11 M55 | 55 | 49 |
| RS378B P15 M55 | 55 | 49 |
| RS378B P24 M70 | 70 | 90 |
| RS378B P33 M87 | 87 | 107 |
| RS378B P42 M102 | 102 | 116 |

