



LuxSpace Compact, surface & suspended

DN610C 20S/840 PSU-E BKR BK

LuxSpace Compact, surface & suspended, downlight, 23 W, 2200 lm, 4000 K, UGR19, IP20

downlight, Plastic, White, Surface, Power supply unit external (On/Off), 2200 lm, 23 W, 96 lm/W, 4000 K, (0.38,0.38), UGR19, IP20 | Finger-protected, IK02 | 0.2 J standard, Safety class II

Product data

General Information	
Number of gear units	1 unit
Driver included	Yes
Mounting	Surface
Value ladder	Specification
Warranty period	5 years

Light Technical	
Luminous Flux	2,200 lm
Correlated Color Temperature (Nom)	4000 K
Luminous Efficacy (rated) (Nom)	96 lm/W
Color rendering index (CRI)	>80
Light source color	840 neutral white
Optic type	-
Luminaire light beam spread	-
Unified glare rating CEN	19

Operating and Electrical	
Input Voltage	220-240 V
Line Frequency	50 to 60 Hz
Inrush current	14.5 A
Inrush time	0.150 ms
Power Consumption	23 W
Power Factor (Fraction)	0.9
Connection	-
Cable	-
Number of products on MCB of 16 A type B	54
Suitable for random switching	No
Protection class IEC	Safety class II

Controls and Dimming	
Dimmable	No
Driver/power unit/transformer	Power supply unit external (On/Off)

LuxSpace Compact, surface & suspended

Constant light output	No
-----------------------	----

Mechanical and Housing

Housing Material	Plastic
Reflector material	Polycarbonate
Optic material	-
Optical cover material	-
Fixation material	-
Housing Color	White
Optical cover finish	-
Overall height	230 mm
Overall diameter	200 mm
Ingress protection code	IP20 [Finger-protected]
Mech. impact protection code	IK02 [0.2 J standard]
Mounting	Surface
Net Weight (Piece)	1.100 kg

Approval and Application

Glow-wire test	Temperature 650 °C, duration 30 s
Flammability mark	For mounting on normally flammable surfaces
CE mark	Yes
ENEC mark	-
Photobiological risk	Photobiological risk group 0 @200mm to EN62778
EU RoHS compliant	Yes
Performance ambient temperature Tq	25 °C
Ambient temperature range	+10 to +35 °C

Initial Performance (IEC Compliant)

Luminous flux tolerance	-10% / +10%
Initial chromaticity	(0.38,0.38)
Power consumption tolerance	+/-10%

Over Time Performance (IEC Compliant)

Control gear failure rate at median useful life 50000 h	5 %
Lumen maintenance (EN-IEC 62722-2-1) at median useful life* 50000 h	L90

Sustainability Data

Sustainability rating	Unclassified
Repair class	Repair Class B, the driver and light source of this luminaire can be replaced by a service technician. Parts and documentation are available for an extended period of time.
Embedded carbon (A1-A3)	16 kg CO ₂ e
Product non-virgin material ratio	7.12 %
Recyclable content ratio of the finished product	28.7 %
GWP total B6 (kg CO ₂ eq) Declared Unit	Please calculate using your local energy mix value: Power Declared Unit (kW) * Service life (hrs) Declared Unit * Energy mix (kg CO ₂ eq / kwh)
GWP total B6 (kg CO ₂ eq) Functional Unit	Please calculate using your local energy mix value: Power Declared Unit (kW) * 1000 (lm) / lumen output (lm) Declared Unit * 35000 (hrs) * Energy mix (kg CO ₂ eq / kwh)
Non-virgin material ratio of the packaging	Cardboard > 80% recycled
Packaging Recyclable content ratio	Cardboard recycling rate > 80%
Packaging Material	Cardboard

Product Data

Order product name	DN610C 20S/840 PSU-E BKR BK
Full product name	DN610C 20S/840 PSU-E BKR BK
Full product code	872016983770600
Order code	910505104880
Material Nr. (12NC)	910505104880
Numerator - Quantity Per Pack	1
EAN/UPC - Product/Case	8720169837706
Numerator - Packs per outer box	1
EAN/UPC - Case	8720169837706
Product family code	DN610C [LuxSpace, surface mounted]

LuxSpace Compact, surface & suspended

Dimensional drawing

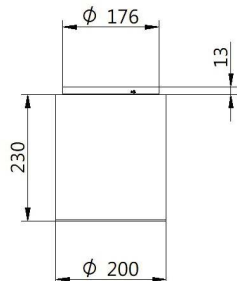

Photometric data

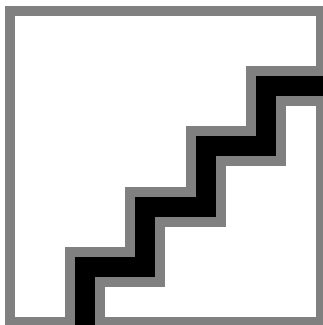

Polar Normal (separate) - DN610CI - 910505104880

