



# LuxSpace Compact, surface & suspended

## DN610C 20S/840 PSU-E M WH

LuxSpace Compact, surface & suspended, 18 W, 2100 lm, 4000 K

Philips LuxSpace is designed to provide the perfect combination of efficiency, high visual comfort, and stylish design without compromising on lighting performance. LuxSpace offers a long lifetime and efficacy of up to 175 lm/W, along with excellent color rendering and light distribution which have a major influence on the visual and non-visual effects of light on human health and well-being. The LuxSpace downlight family offers a wide choice of options for creating the desired ambience and supporting user comfort, no matter what the application is.

### Product data

General Information		Optic type	
Number of gear units	1 unit	Optic type	-
Driver included	Yes	Luminaire light beam spread	-
Mounting	Surface	Unified glare rating CEN	19
Value ladder	Specification	<b>Operating and Electrical</b>	
Warranty period	5 years	Input Voltage	220-240 V
Sustainability rating	Unclassified	Line Frequency	50 to 60 Hz
<b>Light Technical</b>		Inrush current	9.92 A
Luminous Flux	2,100 lm	Inrush time	0.230 ms
Correlated Color Temperature (Nom)	4000 K	Power Consumption	18 W
Luminous Efficacy (rated) (Nom)	117 lm/W	Power Factor (Fraction)	0.9
Color rendering index (CRI)	80	Connection	-
Light source color	840 neutral white	Cable	-
		Number of products on MCB of 16 A type B	64

## LuxSpace Compact, surface & suspended

Suitable for random switching	No
Protection class IEC	Safety class II

### Controls and Dimming

Dimmable	No
Driver/power unit/transformer	Power supply unit external (On/Off)
Constant light output	No

### Mechanical and Housing

Housing Material	Plastic
Reflector material	Polycarbonate
Optic material	-
Optical cover material	-
Fixation material	-
Housing Color	White
Optical cover finish	-
Overall height	230 mm
Overall diameter	200 mm
Ingress protection code	IP20 [Finger-protected]
Mech. impact protection code	IK02 [0.2 J standard]
Net Weight (Piece)	1.100 kg

### Approval and Application

Glow-wire test	Temperature 650 °C, duration 30 s
Flammability mark	For mounting on normally flammable surfaces
CE mark	Yes
ENEC mark	-
Photobiological risk	Photobiological risk group 0 @200mm to EN62778

EU RoHS compliant	Yes
Performance ambient temperature Tq	25 °C
Ambient temperature range	+10 to +35 °C

### Initial Performance (IEC Compliant)

Luminous flux tolerance	-10% / +10%
Initial chromaticity	(0.38,0.38)
Power consumption tolerance	+/-10%

### Over Time Performance (IEC Compliant)

Control gear failure rate at median useful life 50000 h	5 %
Lumen maintenance (EN-IEC 62722-2-1) at median useful life* 50000 h	L90

### Product Data

Order product name	DN610C 20S/840 PSU-E M WH
Full product name	DN610C 20S/840 PSU-E M WH
Full product code	872016983763800
Order code	910505104873
Material Nr. (12NC)	910505104873
Numerator - Quantity Per Pack	1
EAN/UPC - Product/Case	8720169837638
Numerator - Packs per outer box	1
EAN/UPC - Case	8720169837638
Product family code	DN610C [LuxSpace, surface mounted]

## Dimensional drawing

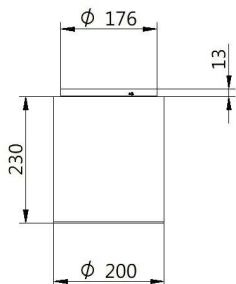

## LuxSpace Compact, surface & suspended

### Photometric data



Polar Normal (separate) - DN610CI - 910505104873

