



# LuxSpace Accent Compact Elbow

## RS772B 49S/PW930 PSU-E HWB WH

LuxSpace Accent Compact Elbow, Recessed, 38 W, D125 mm, 5200 lm, 3000 K, CRI>90, High-reflective metal reflector Wide beam 40 to 80 degrees, PerfectAccent reflector, White, IP20

Recessed, D125 mm, Aluminium, White, Signal white (RAL9003), Recessed, Power supply unit external (On/Off), 5200 lm, 38 W, 137 lm/W, 3000 K, (0.422,0.386)<2, CRI>90, High-reflective metal reflector Wide beam 40 to 80 degrees, PerfectAccent reflector, IP20 | Finger-protected, IK02 | 0.2 J standard, Safety class II, 2 push-in connectors 2-pole

### Warnings and Safety

- All photometrical data is calculated without optional front glass. Flux should be reduced by 3.5% when using a front glass
- Cleaning of the optic should only be done with pressurised air. Touching the LED or reflector is forbidden. For food preparation areas and areas with high levels of dust, the use of the optional front glass is strongly advised, as it can be cleaned with a (dry) microfibre cloth
- During maintenance, the product must be switched off and cooled down
- The product must be installed out of arm's reach. Manipulating the product when hot is only possible with an insulated glove

### Product data

General Information		Warranty period	
Light source replaceable	No	5 years	
Number of gear units	Unit	Light Technical	
Driver included	Yes	Luminous Flux	5,200 lm
Service Tag	Yes	Correlated Colour Temperature (Nom)	3000 K
Lighting Technology	LED	Luminous efficacy (rated) (nom.)	137 lm/W
Value ladder	Specification	Colour rendering index (CRI)	>90

# LuxSpace Accent Compact Elbow

Beam angle of light source	120 degree(s)
Light source colour	PremiumWhite with CRI ≥90 and colour temperature 3,000K
Optic type	High-reflective metal reflector Wide beam 40 to 80 degrees
Luminaire light beam spread	36°
Unified Glare Rating (CEN)	22

## Operating and Electrical

Input Voltage	220 to 240 V
Line Frequency	50 to 60 Hz
Initial CLO power consumption	- W
Average CLO power consumption	- W
Inrush current	12 A
Inrush time	100 ms
Power Consumption	38 W
Power Factor (Fraction)	0.9
Connection	2 push-in connectors 2-pole
Cable	-
Number of products on MCB (16 A type B)	24
Suitable for random switching	No
Protection class IEC	Safety class II
Total harmonic distortion	20 %

## Controls and Dimming

Dimmable	No
Driver/power unit/transformer	Power supply unit external (On/Off)
Constant light output	No
Maximum dim level	Not applicable

## Mechanical and Housing

Housing material	Aluminium
Reflector material	Aluminium
Optic material	Aluminium
Optical cover/lens material	-
Fixation material	-
Housing Colour	White
Optical cover/lens finish	-
Reflector finish	PerfectAccent reflector
Overall length	0 mm
Overall width	0 mm
Overall height	110 mm
Overall diameter	134 mm
Dimensions (height x width x depth)	110 x 0 x 0 mm
Ingress protection code	IP20 [Finger-protected]
Mech. impact protection code	IK02 [0.2 J standard]
Mounting	Recessed
Net Weight (Piece)	1.000 kg

## Approval and Application

Glow-wire test	Temperature 650 °C, duration 30 s
----------------	-----------------------------------

Flammability mark	For mounting on normally flammable surfaces
CE mark	Yes
ENEC mark	ENEC mark
Photobiological risk	Photobiological risk group 1 @200mm to EN62778
EU RoHS compliant	Yes
Performance ambient temperature Tq	25 °C
Flickering value (PstLM)	1
Stroboscopic effect	0.5
Ambient temperature range	+10 to +35 °C

## Initial Performance (IEC Compliant)

Luminous flux tolerance	+/-10%
Initial chromaticity	(0.422,0.386)<2
Power consumption tolerance	+/-10%
Standard Deviation of Colour Matching (McAdam ellipse)	SDCM≤2

## Over Time Performance (IEC Compliant)

Control gear failure rate at median useful life 50,000 h	10 %
Control gear failure rate at median useful life 100,000 h	10 %
Lumen maintenance (EN-IEC 62722-2-1) at median useful life* 50000 h	L90
Lumen maintenance (EN-IEC 62722-2-1) at median useful life* 100000 h	L85

## Sustainability Data

Sustainability rating	Signify Circle
Repair class	Repair Class B, the driver and light source of this luminaire can be replaced by a service technician. Parts and documentation are available for an extended period of time.
Embedded carbon (A1-A3)	6.22 kg CO <sub>2e</sub>
Product non-virgin material ratio	8.31 %
Recyclable the content ratio of the finished product	12.5 %
GWP total B6 (kg CO <sub>2eq</sub> ) Declared Unit	Please calculate using your local energy mix value: Power Declared Unit (kW) * Service life (hrs) Declared Unit * Energy mix (kg CO <sub>2eq</sub> / kWh)
GWP total B6 (kg CO <sub>2eq</sub> ) Functional Unit	Please calculate using your local energy mix value: POWER DECLARED UNIT (kW) * 1000 (lm) / LUMEN OUTPUT DECLARED UNIT (lm) * 35000 (hrs) * ENERGY MIX (kg CO <sub>2</sub> eq / kWh)

## Product Data

Order product name	RS772B 49S/PW930 PSU-E HWB WH
Full product name	RS772B 49S/PW930 PSU-E HWB WH

# LuxSpace Accent Compact Elbow

Full EOC	871869997934800
Order code	910505101620
Material no. (12 NC)	910505101620
Numerator – quantity per pack	1
EAN/UPC – Product/Case	8718699979348
Numerator – packs per outer box	1

EAN/UPC - Case	8718699979348
Product family code	RS772B [LUXSPACE ACCENT COMPACT ELBOW RPO]

## Dimensional drawing

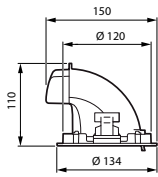
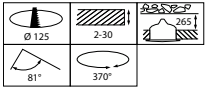

## Photometric data

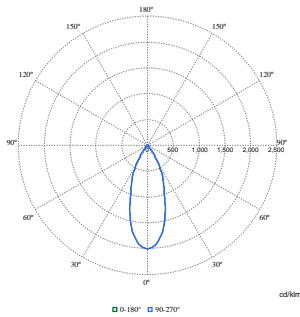

Polar Normal (separate) - RS770BI - 910505101620

