



LuxSpace Accent Compact Elbow

RS772B 27S/ROSE PSU-E HWB FG WH

LuxSpace Accent Compact Elbow, Recessed, 31 W, D125 mm, 2900 lm, Rosé, 2200 K, High-reflective metal reflector Wide beam 40 to 80 degrees, PerfectAccent High-Efficacy reflector, White, IP20

With LuxSpace Accent Compact Elbow, retailers and building operators can enjoy the superior quality of light and market-leading energy efficiency of PerfectAccent optics in a refined and neutral product design. Powerful and discreet, LuxSpace Accent combines a high luminous flux in a compact form factor. Design-in and installation are easy due to its small built-in dimensions. Maintenance and upgrades of the optics is fast and requires no tools. Furthermore, LuxSpace Compact Elbow spots are certified as circular lighting and offer multiple system integration and dimming options, including wired as well as wireless. LuxSpace Accent Compact Elbow allows spot head rotation and can be angled out of the ceiling for maximum aiming flexibility. For prolonged shelf life and better visual representation of food, reducing food waste and increasing sales, fresh food LED lighting recipes are available. Check out our Fashion and Food catalog pages to find out more about PremiumWhite, PremiumColor, Fresh Meat, Rosé, Frost and Champagne.

Warnings and Safety

- All photometrical data is calculated without optional front glass. Flux should be reduced by 3.5% when using a front glass
- Cleaning of the optic should only be done with pressurized air. Touching the LED or reflector is forbidden. For food preparation areas and areas with high levels of dust, the use of the optional front glass is strongly advised, as it can be cleaned with a (dry) microfiber cloth
- During maintenance, the product must be switched off and cooled down
- The product must be installed out of arm's reach. Manipulating the product when hot is only possible with an insulated glove

LuxSpace Accent Compact Elbow

Product data

General Information			
Light source replaceable	No	Optical cover finish	Clear
Number of gear units	1 unit	Reflector Finish	PerfectAccent High-Efficacy reflector
Driver included	Yes	Overall length	0 mm
Service tag	Yes	Overall width	0 mm
Lighting Technology	LED	Overall height	110 mm
Value ladder	Specification	Overall diameter	134 mm
Warranty period	5 years	Dimensions (Height x Width x Depth)	110 x 0 x 0 mm
		Ingress protection code	IP20 [Finger-protected]
		Mech. impact protection code	IK02 [0.2 J standard]
		Net Weight (Piece)	1.000 kg
Light Technical		Approval and Application	
Luminous Flux	2,900 lm	Glow-wire test	Temperature 650 °C, duration 30 s
Correlated Color Temperature (Nom)	2200 K	Flammability mark	For mounting on normally flammable surfaces
Luminous Efficacy (rated) (Nom)	93 lm/W	CE mark	Yes
Color rendering index (CRI)	>80	ENEC mark	ENEC mark
Beam angle of light source	120 degree(s)	Photobiological risk	Photobiological risk group 1 @200mm to EN62778
Light source color	Rosé	EU RoHS compliant	Yes
Optic type	High-reflective metal reflector Wide beam 40 to 80 degrees	Performance ambient temperature Tq	25 °C
Luminaire light beam spread	36°	Flickering value (PstLM) - Flickering value as per EN 61000-3-3	1
Unified glare rating CEN	22	Stroboscopic effect visibility measure (SVM)	0.5
Operating and Electrical		Ambient temperature range	+10 to +35 °C
Input Voltage	220 to 240 V	Initial Performance (IEC Compliant)	
Line Frequency	50 to 60 Hz	Luminous flux tolerance	+/-10%
Initial CLO power consumption	- W	Initial chromaticity	(0.478,0.382)<2
Average CLO power consumption	- W	Power consumption tolerance	+/-10%
Inrush current	11.1 A	Standard Deviation of Colour Matching (McAdam ellipse)	SDCM≤2
Inrush time	250 ms	Over Time Performance (IEC Compliant)	
Power Consumption	31 W	Control gear failure rate at median useful life 50000 h	10 %
Power Factor (Fraction)	0.9	Control gear failure rate at median useful life 100000 h	10 %
Connection	2 Push-in connector 2-pole	Lumen maintenance (EN-IEC 62722-2-1) at median useful life* 50000 h	L85
Cable	-	Lumen maintenance (EN-IEC 62722-2-1) at median useful life* 100000 h	L80
Number of products on MCB of 16 A type B	49	Sustainability Data	
Suitable for random switching	No	Sustainability rating	Unclassified
Protection class IEC	Safety class II	Serviceability class	Class A, luminaire is equipped with serviceable parts (when applicable): LED board, driver, control units, surge protection
Total harmonic distortion	20 %		
Controls and Dimming			
Dimmable	No		
Driver/power unit/transformer	Power supply unit external (On/Off)		
Constant light output	No		
Maximum dim level	Not applicable		
Mechanical and Housing			
Housing Material	Aluminum		
Reflector material	Aluminum		
Optic material	Aluminum		
Optical cover material	Tempered glass		
Fixation material	-		
Housing Color	White		

LuxSpace Accent Compact Elbow

	device, optics, front cover and mechanical parts
Embedded carbon (A1-A3)	6.22 kg CO ₂ e
Product non-virgin material ratio	8.31 %
Recyclable content ratio of the finished product	12.5 %
GWP total B6 (kg CO₂eq) Declared Unit	Please calculate using your local energy mix value: Power Declared Unit (kW) * Service life (hrs) Declared Unit * Energy mix (kg CO ₂ eq / kWh)
GWP total B6 (kg CO₂eq) Functional Unit	Please calculate using your local energy mix value: Power Declared Unit (kW) * 1000

	(lm) /lumen output (lm) Declared Unit * 35000 (hrs) * Energy mix (kg CO ₂ eq / kWh)
Product Data	
Order product name	RS772B 27S/ROSE PSU-E HWB FG WH
Full product name	RS772B 27S/ROSE PSU-E HWB FG WH
Full product code	871869997921800
Order code	910505101607
Material Nr. (12NC)	910505101607
Numerator - Quantity Per Pack	1
EAN/UPC - Product/Case	8718699979218
Numerator - Packs per outer box	1
EAN/UPC - Case	8718699979218
Product family code	RS772B [LUXSPACE ACCENT COMPACT ELBOW RPO]

Dimensional drawing

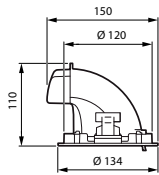
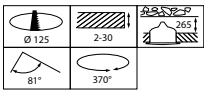

Photometric data

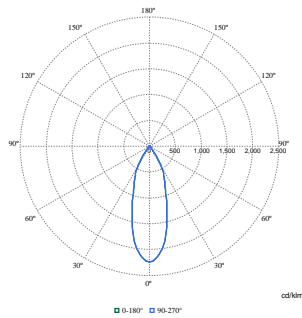

Polar Normal (separate) - RS770BI - 910505101607

LuxSpace Accent Compact Elbow

