



StyliD Evo

ST780T LED60S/830 PSU HMB WH

StyliD Evo, Performance, track projector, 44 W, 6000 lm, 3000 K, High-reflective metal reflector Medium beam 20 to 40 degrees, White

With StyliD Evo, retailers can enjoy the superior quality of light and market-leading energy efficiency of PerfectAccent optics in a series of flexible and future-proof projectors. StyliD Evo projectors are easy to reconfigure with quick and easy optic upgrades that require no tools. They also support frequent changes in store layouts, as the StyliD Evo projector can be easily repositioned on the track or Maxos fusion backbone. Covering a wide range of lighting applications, from lower light levels in convenience formats to high-ceiling installations where very high light output is required, StyliD offers continuity for every retail concept. StyliD Evo can be mounted on 3C or DALI track (ST770T, ST780T), on Maxos fusion (ST770S, ST780S, ST770X), or into the ceiling with a semi-recessed version (ST770B). All StyliD Evo projectors with PerfectAccent reflectors are certified as a circular lighting product and offer multiple system integration and dimming options, including wired as well as wireless. For prolonged shelf life and better visual representation of food, reducing food waste and increasing sales, fresh food LED lighting recipes are available. Check out our Fashion and Food catalog pages to find out more about PremiumWhite, PremiumColor, Fresh Meat, Rosé, Frost and Champagne.

Warnings and Safety

- All photometrical data is calculated without optional front glass. Flux should be reduced by 3.5% when using a front glass
- Cleaning of the optic should only be done with pressurized air. Touching the LED or reflector is forbidden. For food preparation areas and areas with high levels of dust, the use of the optional front glass is strongly advised, as it can be cleaned with a (dry) microfiber cloth.
- During maintenance, the product must be switched off and cooled down
- The product must be installed out of arm's reach. Manipulating the product when hot is only possible with an insulated glove

Product data

StyliD Evo

General Information	
Light source replaceable	No
Number of gear units	1 unit
Driver included	Yes
Service tag	Yes
Lighting Technology	LED
Value ladder	Specification
Serviceability class	Class A, luminaire is equipped with serviceable parts (when applicable): LED board, driver, control units, surge protection device, optics, front cover and mechanical parts
Warranty period	5 years
Sustainability rating	Signify Circle

Light Technical	
Luminous Flux	6,000 lm
Correlated Color Temperature (Nom)	3000 K
Luminous Efficacy (rated) (Nom)	143 lm/W
Color rendering index (CRI)	>80
Beam angle of light source	120 degree(s)
Light source color	830 warm white
Optic type	High-reflective metal reflector Medium beam 20 to 40 degrees
Luminaire light beam spread	24°
Unified glare rating CEN	22

Sustainability Data	
Embedded carbon (A1-A3)	21.3 kg CO ₂ e
Recyclable content ratio of the finished product	47 %
Product non-virgin material ratio	8.18 %
GWP total B6 (kg CO ₂ eq) Declared Unit	Please calculate using your local energy mix value: Power Declared Unit (kW) * Service life (hrs) Declared Unit * Energy mix (kg CO ₂ eq / kwh)
GWP total B6 (kg CO ₂ eq) Functional Unit	Please calculate using your local energy mix value: Power Declared Unit (kW) * 1000 (lm) /lumen output (lm) Declared Unit * 35000 (hrs) * Energy mix (kg CO ₂ eq / kwh)

Operating and Electrical	
Input Voltage	220 to 240 V
Line Frequency	50 to 60 Hz
Inrush current	18 A
Inrush time	250 ms
Power Consumption	44 W
Power Factor (Fraction)	0.9
Connection	3C Track
Cable	-
Number of products on MCB of 16 A type B	30

Suitable for random switching	No
Protection class IEC	Safety class II
Total harmonic distortion	20 %

Controls and Dimming	
Dimmable	No
Driver/power unit/transformer	Power supply unit (On/Off)
Constant light output	No
Maximum dim level	Not applicable

Mechanical and Housing	
Housing Material	Aluminum
Reflector material	Aluminum
Optic material	Aluminum and polycarbonate
Optical cover material	-
Fixation material	-
Housing Color	White
Optical cover finish	-
Overall length	240 mm
Overall width	120 mm
Overall height	260 mm
Dimensions (Height x Width x Depth)	260 x 120 x 240 mm
Ingress protection code	IP20 [Finger-protected]
Mech. impact protection code	IK02 [0.2 J standard]
Net Weight (Piece)	1.300 kg

Approval and Application	
Glow-wire test	Temperature 650 °C, duration 30 s
Flammability mark	For mounting on normally flammable surfaces
CE mark	Yes
ENEC mark	ENEC mark
Photobiological risk	Photobiological risk group 1 @200mm to EN62778
EU RoHS compliant	Yes
Performance ambient temperature Tq	25 °C
Flickering value (PstLM) - Flickering value as per EN 61000-3-3	1
Stroboscopic effect visibility measure (SVM)	0.5
Ambient temperature range	+10 to +35 °C

Initial Performance (IEC Compliant)	
Luminous flux tolerance	+/-10%
Initial chromaticity	(0.434,0.403)<3
Power consumption tolerance	+/-10%
Standard Deviation of Colour Matching (McAdam ellipse)	SDCM≤3

Over Time Performance (IEC Compliant)	
Control gear failure rate at median useful life 50000 h	5 %

StyliD Evo

Control gear failure rate at median useful life 100000 h	3.1 %
Lumen maintenance (EN-IEC 62722-2-1) at median useful life* 50000 h	L90
Lumen maintenance (EN-IEC 62722-2-1) at median useful life* 100000 h	L80
Product Data	
Order product name	ST780T LED60S/830 PSU HMB WH
Full product name	ST780T LED60S/830 PSU HMB WH

Full product code	871951401021500
Order code	910505100755
Material Nr. (12NC)	910505100755
Numerator - Quantity Per Pack	1
EAN/UPC - Product/Case	8719514010215
Numerator - Packs per outer box	1
EAN/UPC - Case	8719514010215
Product family code	ST780T [StyliD Evo Performance]

Dimensional drawing

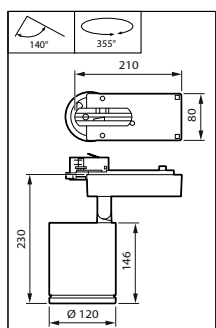

Photometric data

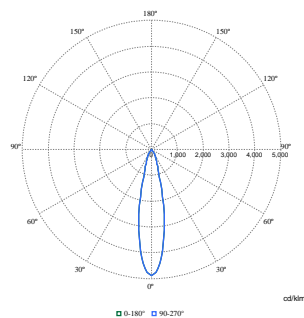

Polar Normal (separate) - ST780TI - 910505100755

