

Installation Procedure for LOW VOLTAGE IC FRAME IN KITS 2004ICV, 2004ICVN

READ AND UNDERSTAND THESE INSTRUCTIONS BEFORE INSTALLING THE LUMINAIRE.

This fixture is intended for installation in accordance with the National Electrical Code and local regulations. To assure full compliance with local codes and regulations, check with your local electrical inspector before installation. To prevent electrical shock, turn off electricity at fuse box before proceeding.

Retain these instructions for maintenance reference and warranty information.

NEW CONSTRUCTION

NOTE: I.C. FRAM-in KIT may be used in direct contact with insulation.

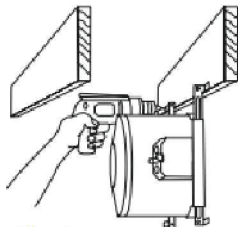

Fig. A
Frame-In

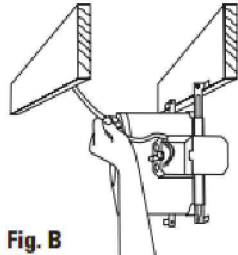

Fig. B
Wire-In

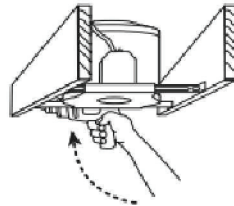

Fig. C
Swing-Up



Fig. D
Close-In

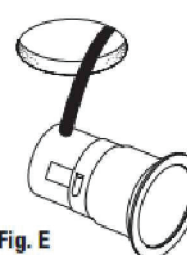

Fig. E
Snap-On

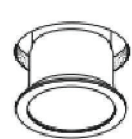
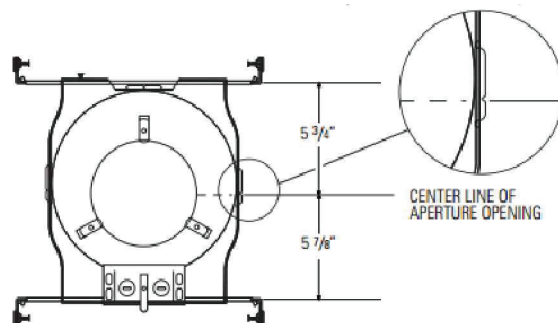

Fig. F
Push-Up

WARNING: USE ONLY WITH LIGHTOLIER REFLECTOR TRIMS MARKED WITH I.C. LAMPING INFORMATION. USE OF OTHER MANUFACTURERS' TRIMS VOIDS THE UNDERWRITERS LABORATORIES LISTING AND COULD CONSTITUTE A FIRE HAZARD

1. Frame-In (Fig. A):

Locate fixture along joist and line up bottom edge of HINGED MOUNTING BAR with the bottom of joist and fasten in place.



Note: Integral nail version available

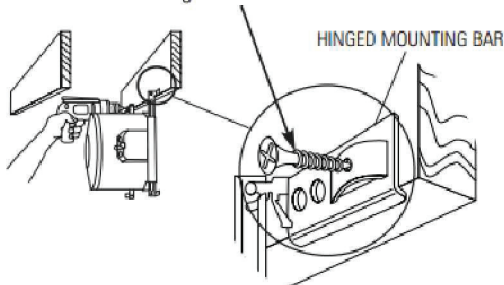

HINGED MOUNTING BAR

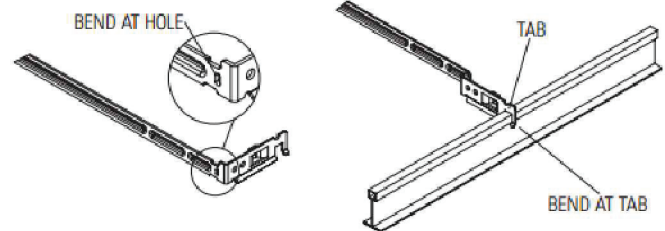

For suspended ceilings:

- Rotate HINGED BAR ENDS to position shown below and fully extend bars.
- Crimp bottom of edge of CHANNEL to prevent rotation of HINGED BAR ENDS.
- Bend NON-HINGED end of mounting bar at featured hole location and extend out.
- Position notched area of MOUNTING BARS onto T-BAR and lock by bending TAB underneath T-BAR BEAD as shown.
- For suspended ceiling, make certain that bottom of MOUNTING FRAME is no higher than 1" above ceiling line

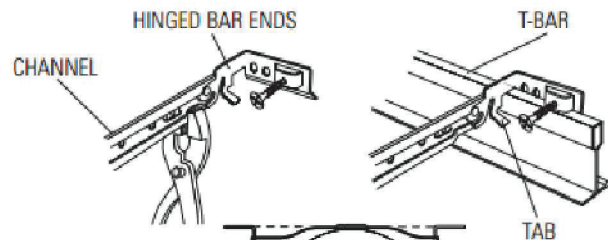

HINGED BAR ENDS

CHANNEL

T-BAR

TAB

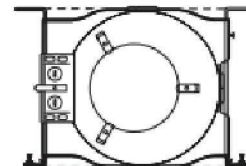

Fig. G

FOR JOIST SPACING LESS THAN 16" ON CENTER (TO 12" ON CENTER):

- MOUNTING BAR CHANNELS can be shortened and used as nailing legs in tight spaces. Simply remove INNER BAR from holed CHANNEL, bend CHANNEL to appropriate point and use extra screw to secure to the joist. (Fig G.)

Philips Lighting North America Corporation

200 Franklin Square Drive

Somerset, NJ 08873, USA

Phone: 855-486-2216

We reserve the right to change details of design, materials and finish.

©2016 Philips Lighting Holding B.V. All rights reserved • D0216

Philips Lighting Canada Ltd.

281 Hillmount Road

Markham ON, Canada L6C 2S3

Phone: 800-668-9008

PHILIPS

2. Wire-In: (Fig. B)

Open hinged J-BOX COVER fully to its locked position (lift slightly to unlock).

Option 1: Remove one of the provided KNOCK OUTS. Insert supplied (or Equivalent) snap in NON-METALLIC CABLE CLAMP into KNOCK OUT. Push cables through single CLAMP.

Note: Snap in supplied CLAMP: Fits NM CABLES #14/2, #14/3, #12/2, #10/2, #10/3,

Option 2: Open hinged KNOCK OUT to allow NON-METALLIC CABLE to enter JUNCTION BOX. Push CABLE through CLAMP.

Note: Wiring and connections must not be placed in JUNCTION BOX in a manner which will interfere with the CLAMPS action to provide strain relief.

Wire to SUPPLY LEADS. WHITE FIXTURE LEAD to NEUTRAL SUPPLY LEAD. BLACK FIXTURE LEAD to HOT (120V) SUPPLY LEAD. BARE FIXTURE WIRE to SUPPLY GROUND. Use wirenuts (local hardware item). Place all electrical connections in the J-BOX and close the J-BOX COVER.

3. Swing-Up (Fig. C):

Extend MOUNTING BAR to reach opposite joist and fasten in place. Adjust FRAME-IN KIT to desired position along MOUNTING BAR and lock in place using locking screw.

4. Close-In (Fig. D):

Install plasterboard or other dry type ceiling. Hole in board can be cut either on the floor or after the board is secured to the ceiling using MOUNTING FRAME opening as cutting guide. Make sure ROTO-CLIPS are rotated out of hole area to be cut, also making sure that socket and wiring are positioned away from hole area. Roto Clips can only be rotated counter-clockwise. This detail allows easy removal of reflector trim by rotating TRIM counterclockwise and permits installing Reflector Trim tightly against ceiling surface by rotating trim clockwise after pushing trim into ceiling using housing opening as a cutting guide. HOUSING is secured by 3 screws which allow adjustment for variable ceiling thickness.

5. AirSeal® Installation (Optional):

Option 1: Install LAS56 Flange Gasket Kit (available separately).

Option 2: Install a bead of silicone caulking compound between the ceiling opening and edge of HOUSING. HOUSINGS are tested in accordance with ASTM E 283 (max 2 cfm @ 75 pa) and comply with WSEC & MEC when installed as instructed.

NOTE: If factory installed tape or knockouts are removed from vertical adjustment slots in housing wall install **LAS56 Flange Gasket Kit** (available separately).

6. SNAP-ON: (Fig. E)

Important - Insert SOCKET CUP in neck of REFLECTOR making sure SPRING TABS fully engage into SLOTS in REFLECTOR.

7. PUSH-UP (Fig. F)

Push REFLECTOR TRIM straight up until it is tight against ceiling.

SEE SEPARATE
REFLECTOR TRIM
INSTRUCTION
SHEETS

Option 1:

Example Supplied CLAMP:

Option 2:

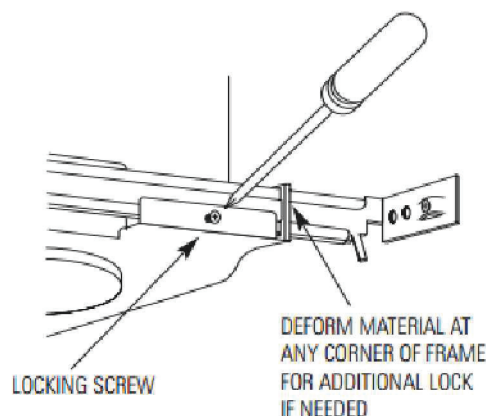
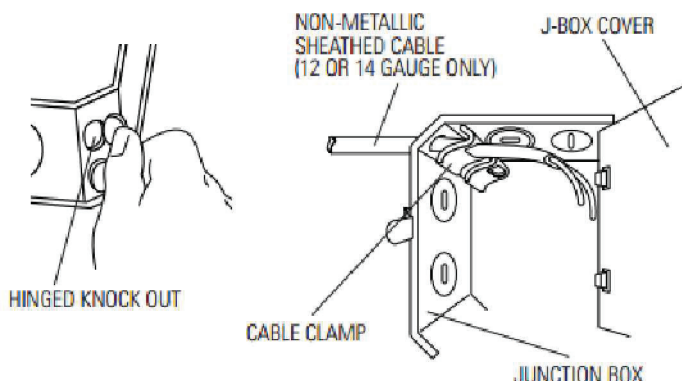
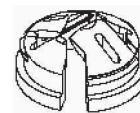

WARNING: WHEN USED WITH LIGHTOLIER REFLECTOR TRIMS 2005, 2005WH, 2017, 2006 PIN SLOT OR 2011 PIN HOLE, FLANGE GASKET PROVIDED MUST BE INSTALLED AS SHOWN BELOW. FAILURE TO DO SUCH WOULD VOID THE UNDERWRITERS LABORATORIES LISTING AND COULD CONSTITUTE A FIRE HAZARD. RETAIN THESE INSTRUCTIONS FOR MAINTENANCE REFERENCE.

Slide gasket over housing body and seat firmly against back of flange. Continue with specific trim instructions



2005
2005WH
2017

2006 PIN SLOT
2011 PIN HOLE

Philips Lighting North America Corporation
200 Franklin Square Drive
Somerset, NJ 08873, USA
Phone: 855-486-2216
We reserve the right to change details of design, materials and finish.
©2016 Philips Lighting Holding B.V. All rights reserved • D0216

Philips Lighting Canada Ltd.
281 Hillmount Road
Markham ON, Canada L6C 2S3
Phone: 800-668-9008

PHILIPS

8. LAMPING: (Fig. H)

1. Make sure that power is OFF when lamping or relamping. Remove LAMP RING from TRIM by pulling straight down.
2. Remove LAMP SHIELD from LAMP RING.
3. Place LAMP SHIELD on back of LAMP(MR-16) and insert both between LAMP SPRINGS until face of lamp sits firmly on GLASS LAMP GUARD (Fig. J).

WARNING: RISK OF FIRE. LAMP SHIELD MUST BE INSTALLED

4. Attach Socket to bi-pin prongs on LAMP.
5. Insert LAMP RING with LAMP SHIELD, LAMP and GLASS LAMP GUARD back into TRIM

NOTE:

1. **LOW VOLTAGE FIXTURES** should be dimmed only with special dimmers intended specifically for that purpose. Use Lightolier Lytemode, Scenist, Crescendo VA, Neptune VA, Precision VA, Easyset VA, Sunrise VA, Radiant VA or equivalent products by others or variable autotransformers or electronic dimmers intended for use with low voltage fixtures.
2. Low voltage fixtures may produce audible sound which may be objectionable in acoustically critical areas.

Fig. H

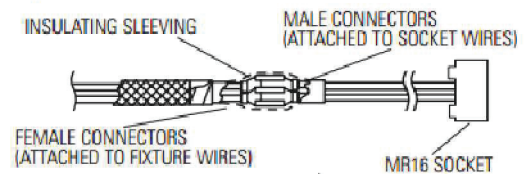
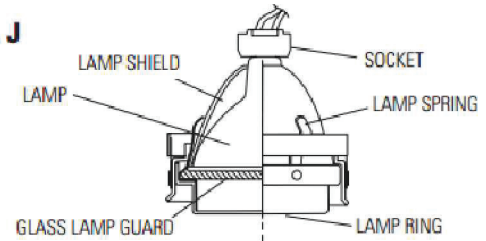

Fig. J



WARNING:

1. LAMP MANUFACTURERS REQUIRE THE GLASS LAMPGUARD BE IN PLACE BEFORE ENERGIZING LAMP, AND THAT GREAT CARE MUST BE TAKEN THAT LAMP IS FULLY COOLED BEFORE RELAMPING. AVOID FINGER MARKS ON INSIDE OF LAMP FOR THEY MAY CAUSE SHORT LAMP LIFE AND POSSIBLE BREAKAGE.
2. USE ONLY REFLECTOR TRIMS PROVIDED BY PHILIPS LIGHTOLIER, USE OF OTHER MANUFACTURER'S REFLECTOR TRIMS VOIDS THE UNDERWRITERS LABORATORIES LISTING AND COULD CONSTITUTE A FIRE HAZARD.

9. AIMING ANGLE ADJUSTMENT: (Fig. K)

1. For Vertical adjustment, insert blade of screwdriver into the open slot of the YOKE.
2. Using the screwdriver as a lever, tilt the entire LAMP HOLDER to the desired angle. 3. For Horizontal adjustment, rotate the LAMP HOLDER.

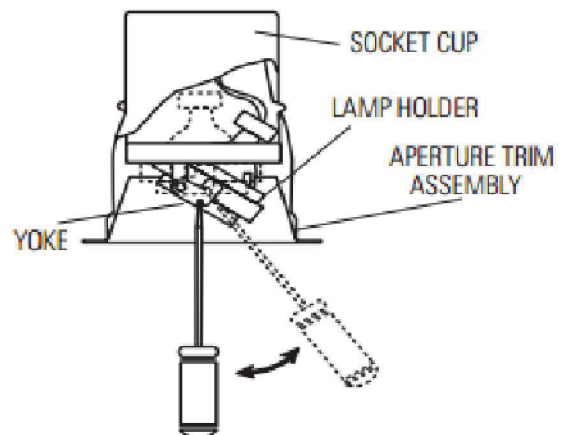

Philips Lighting North America Corporation

200 Franklin Square Drive
Somerset, NJ 08873, USA

Phone: 855-486-2216

We reserve the right to change details of design, materials and finish.

©2016 Philips Lighting Holding B.V. All rights reserved • D0216

Philips Lighting Canada Ltd.

281 Hillmount Road
Markham ON, Canada L6C 2S3

Phone: 800-668-9008

PHILIPS

10. TRANSFORMER REPLACEMENT (Fig. L)

1. Make sure that power is OFF.
2. Remove REFLECTOR TRIM from ceiling.
3. Remove SCREW and lift TRANSFORMER off bracket.
4. Remove J-BOX COVER by removing wing nut.
5. Unsplice primary leads in J-BOX.
6. Remove primary leads from J-BOX cover and clip attached to side of housing.
7. Cut Secondary (red) leads 6" to 8" from TRANSFORMER and discard faulty transformer.
8. Install new TRANSFORMER.

(WARNING: RISK OF FIRE. Transformer contains fixture thermal protector. Replace as shown and described below. Use only replacement transformer obtained from LIGHTOLIER.)

- a. Splice secondary (red) leads to socket leads.
- b. Attach TRANSFORMER to BRACKET with SCREW, making sure that the side of transformer that has the wire leads is facing the housing wall (Fig. L).
- c. Put Primary leads through clip and bushing in J-BOX COVER.
- d. Wire primary leads to supply leads.
- e. Replace J-BOX COVER.
- f. Install REFLECTOR TRIM.

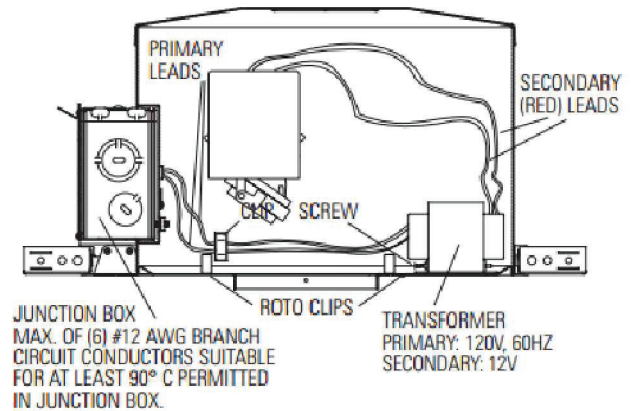

Fig. L

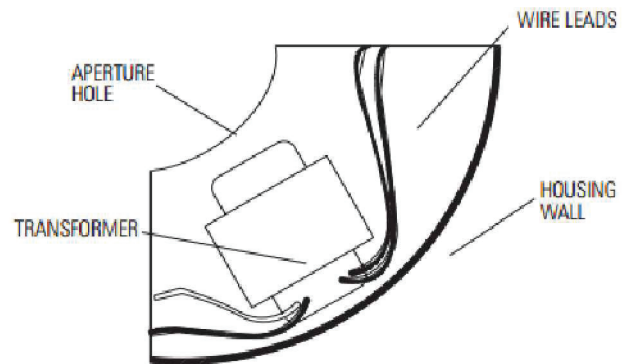

Fig. M