

Read and understand these instructions before installing luminaire. This luminaire is intended for installation in accordance with the National Electrical Code and Local Regulations. To assure full compliance with local codes and regulations, check with your local electrical inspector before installation. To prevent electrical shock, turn off electricity at fuse box before proceeding. Retain these instructions for maintenance reference.

Items needed for Installation:

1. C4L15A_SERIES Finishing Section
2. Phillips Head Screw Driver

Rough-In Section Installation:

See Rough-In Section instruction sheet for installation instructions.

WARNING: TO AVOID PRODUCT FAILURE, DISCONNECT POWER AT SUPPLY PRIOR TO CONNECTING OR DISCONNECTING FINISHING SECTION.

Finishing Section Installation:

Step 1: Connect Power Connector

Connect power connector (from Rough-in Section) to power connector located on the back-side of the Finishing Section heat sink.

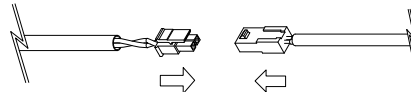

Step 2: Lock Rotating Ring

Ensure that the polished tab, located on the inner-ring of the Rough-In Section, is set in the upright position (locked). This will prevent the inner-ring from rotating during installation.

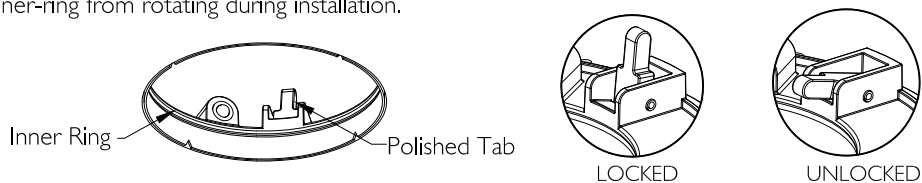

Step 3: Install Finishing Section Into Rough-in Section

The Finishing Section must be in the 'Vertical' Orientation when installing or removing (proper orientation shown below).

- a. Align center of arrow label (located underneath center of side-wall opening) with the center of the polished tab.
- b. While maintaining alignment as specified in Step 3a, simultaneously feed power wire and guide Finishing Section into Rough-in Section opening as shown. As upward force is applied, the textured side-walls of the finishing section will make contact with the bullet-catchers, located in the inner-ring of the Rough-in Section, and will firmly secure the Finishing Section in place if installed correctly. Ensure that the power wire is not pinched and is free-floating once the Finishing Section has been installed.
- c. Push Finishing Section upwards until the bottom of the Finishing Section is approximately even with the ceiling surface.

Note: The maximum ceiling thickness compatibility for all C4L15A_Series Finishing Sections = 1.75"

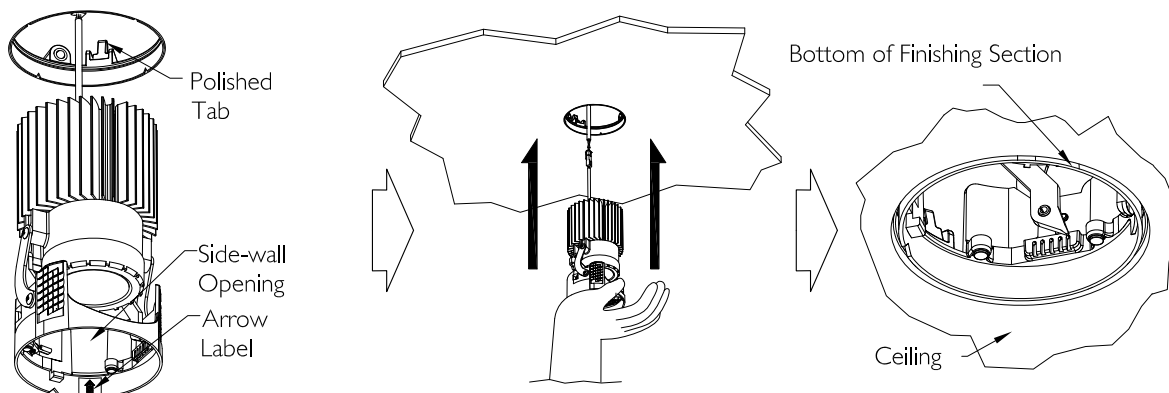

Calculite White LED, 4" Adjustable Accent, Light Engine

Page 2 of 3

Step 4: Adjust Height

Refine height adjustment of finishing section such that the bottom of the finishing section is as close to being level with the ceiling surface as possible; the refined adjustment can be done by rotating the the Finishing Section clockwise to raise or counterclockwise to lower in 0.03" increments.

Note: The flush relationship between the ceiling surface and the bottom of the Finishing Section must be accounted for to ensure that the end product is installed correctly and will function properly.

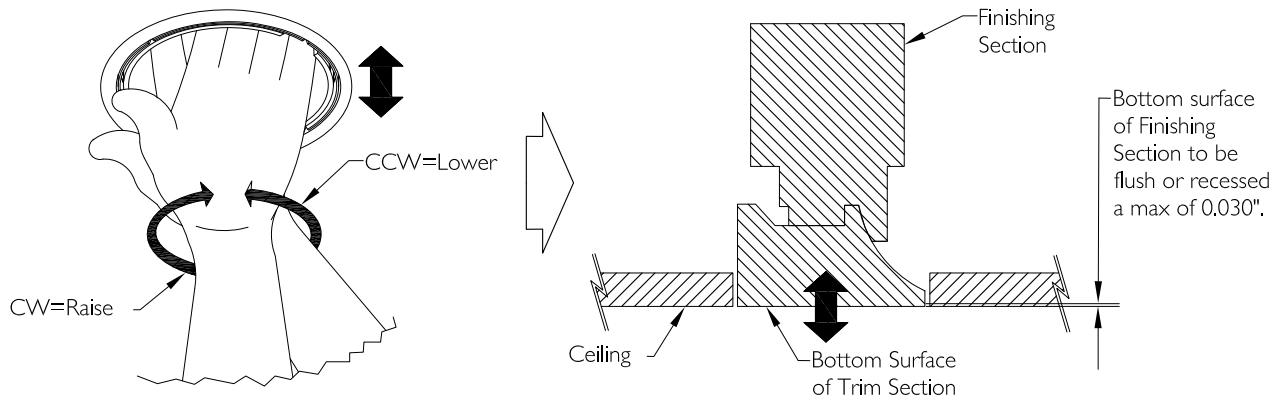
**Step 5: Optional Adjustment Features**

Once step #'s 1-4 have been completed, the Adjustable Finishing Sections can be adjusted to aim the beam of light in order to accent objects, walls, etc. This can be achieved by following the steps below:

Horizontal (Rotational) Adjustability:

This unit is capable of being horizontally adjusted a maximum of 365 degrees, and can be locked in place once adjusted. To do so, reach index finger through aperture-opening, through the slot in the side wall of the Finishing Section (above arrow label), and pull polished tab (from Step 2), downwards. Once in the 'down' position, the finishing section can be rotated freely to aim the beam of light horizontally. Once the unit has been adjusted to the desired position, it can be locked in-place by pushing the polished tab back in to the 'upwards' position.

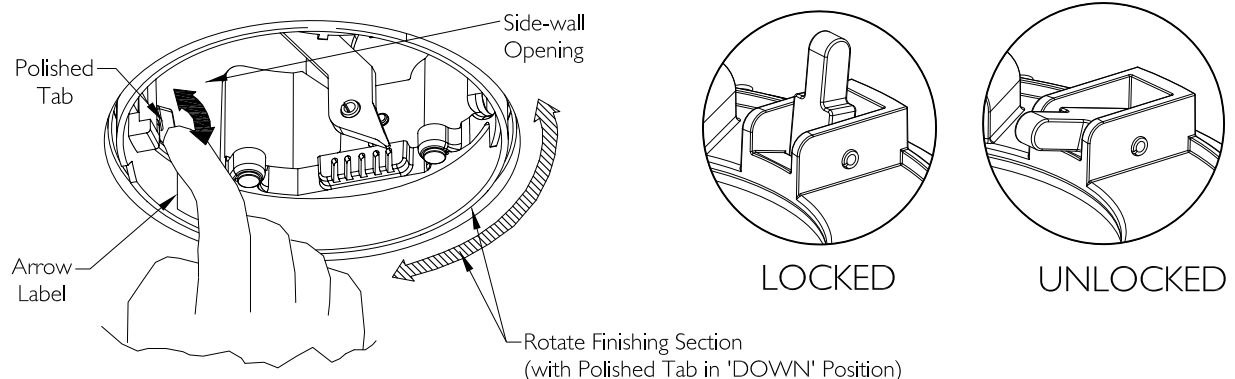
**Step 5 (continued):****Vertical (Angular) Adjustability:**

This unit is capable of being vertically adjusted between 0-40 degrees, and will self-lock in place once adjusted. To do so, using phillips-head screwdriver, turn polished screw-head clockwise to raise, and counterclockwise to lower. While vertically adjusting, the aiming indicator can be used to ensure consistency of aiming between multiple-fixtures. Each notch of the aiming indicator is representative of 10 degrees of adjustment.

Note: While unit is powered up/turned 'ON', aiming CAN be adjusted (Hot-Aiming).

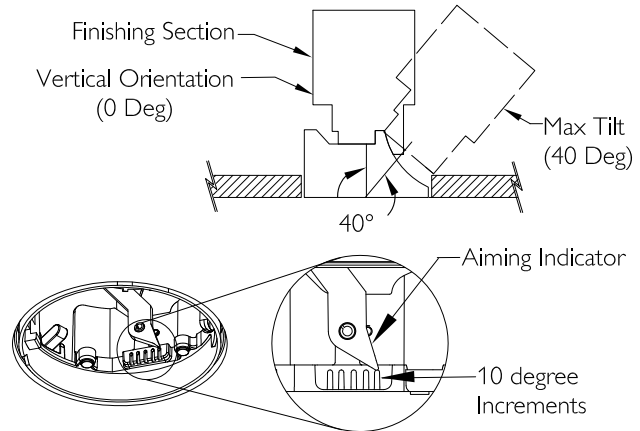
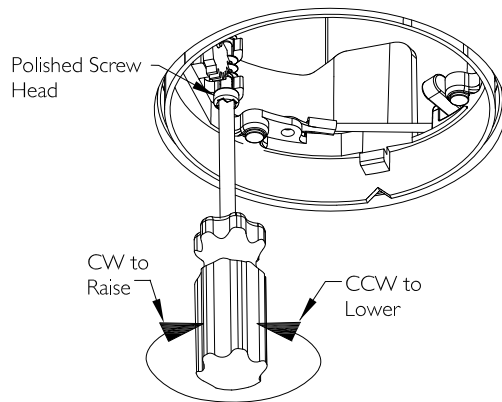

Accessory Installation/Optic Replacement:

If desired, up to $\frac{1}{4}$ " thk of 3.125" diameter Lightolier-brand-accessories (Glass Lenses, Accessory Films, etc.) can be field installed to alter the beam pattern in a variety of different ways. To do so, unscrew the Optic/Accessory Holder and remove from Finishing Section as shown below. Once the Optic/Accessory Holder has been removed, apply pressure to the front surface of the optic assembly with thumbs, while simultaneously holding the ring still with index fingers, and press the optic assembly out from the Threaded Ring. At this point, accessories can be added to the stack of materials OR the stock optic can be replaced with an alternative Lightolier-brand optic if desired. Once alterations have been made, re-stack the assembly and press-fit back into the Threaded Ring, ensuring that the Retaining Ring is fully seated on the bottom of the Threaded Ring. Once assembled, reinstall by screwing optic assembly back onto finishing section. Tighten until the optic assembly will not freely rotate anymore. Do not overtighten, as this could potentially make future replacements more difficult to perform.

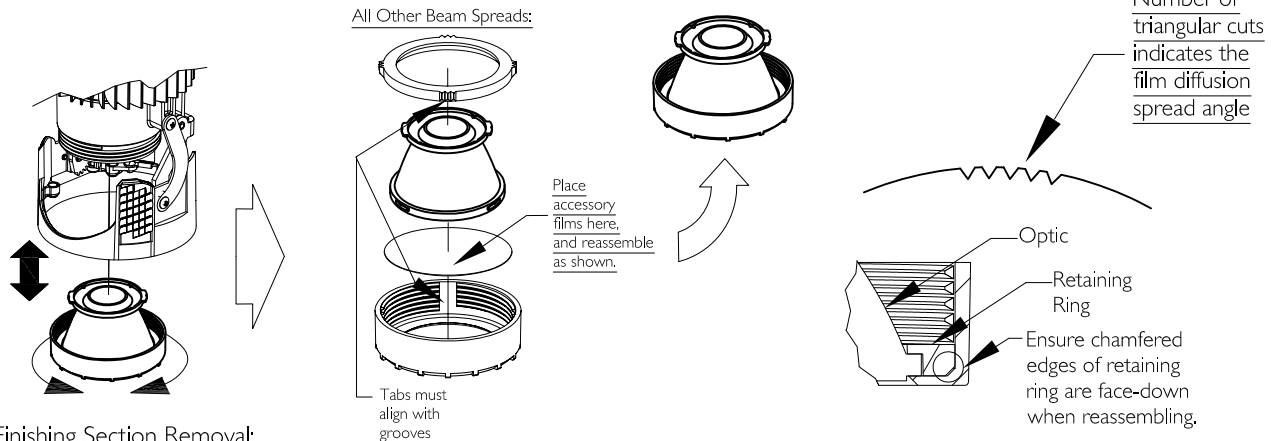

Finishing Section Removal:

- Remove Trim Section (if installed) by grasping edge of reflector flange and pulling downwards. Allow Trim Section to hang by tether.
- Apply pressure to inside of Finishing Section with both hands by pushing outwards on inner cylindrical surface and pull down to remove.
- Disconnect power at power connector.

Trim Section Installation:

See Trim Section (C4LA) instruction sheet for installation instructions.

