



Project: _____

Location: _____

Cat.No: _____

Type: _____

Lamps: _____ Qty: _____

Notes: _____

Ordering guide

Example: **BL5016HS7LED7NFW**

Series	Finish	Mount	Lamp	Optics	CCT
BL5016		S7	LED7		W
BL5016 Aluminum Accent	A Black G Verde H Bronze	S7 Stake	LED7 7W LED	FL Flood NF Narrow Flood	W Warm

Fixture will be shipped with lamp. Lamp not sold separately.

Dimensions

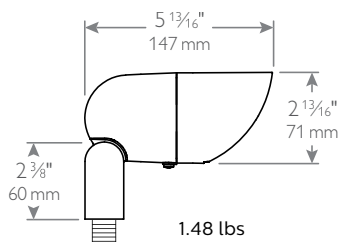

BL5016 FlexScape

Accent Aluminum

Specifications

Features

- 12 Volt
- MR16 LED Lamp
- 1/2" NPS fitter
- Ships with S7 mounting stake

LED

- 460 lumens (dimnable).
- 25,000 hour life (no mercury).
- 7W lamp with 24° or 36° beam spread.
- Color temperature (CCT):
warm white (3,000K nominal).
- Lamp only sold integral to BL5016.

Housing

Die-cast marine grade aluminum alloy with fully-adjustable swivel arm and vibration-proof locking teeth. 1/2" NPS male threads to screw onto accessory mounting stake or junction box (sold separately). Gasketing is silicone and fasteners are 300 series stainless steel.

Shroud

Fully-rotatable, double gasketed, die-cast marine grade aluminum alloy.

Finish

Thermoset powder coated in; black, bronze, or hand-rubbed verde antiqued over black. Electrostatically applied after a five-stage conversion cleaning process and bonded by heat fusion thermosetting.

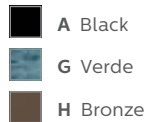

Optics

Clear tempered glass, affixed at 10° angle for natural cleaning.

Wiring

This 12 Volt fixture is pre-wired with a 3 ft. pigtail of 18-2 AWG, 105° C, SPT-1W wire for easy hookup to the low voltage supply cable. Low voltage quick connector, catalog #LVC3 included for easy hook-up to the low voltage supply cable (not included). 12 Volt system requires remote transformer (not included).

Socket

Bi-pin socket type (GU5.3) with 250° C high temperature teflon coated wire leads. Stainless steel retention clip affixed to socket to securely hold lamp in place.

Labels

ETL and cETL listed.
5-year limited warranty.

