

# LIGHTOLIER

by  Signify

IS-3R

Downlighting

REMODELER KITS

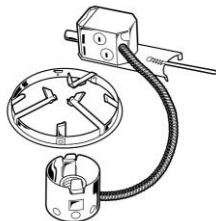

Read and understand these instructions before installing luminaire (fixture)



This fixture is intended for installation in accordance with the National Electrical Code and local regulations. To assure full compliance with local codes and regulations, check with your local electrical inspector before installation. To prevent electrical shock, turn off electricity at fuse box before proceeding.

Retain these instructions for maintenance reference and warranty information.

## Installation for

- 2003R (3 3/4")
- 1003R (5")
- 1103R (6 3/4")

## WARNING: (RISK OF FIRE)

Do not install insulation within 3" of fixtures sides or wiring compartment, not above fixture in such a manner so as to entrap heat.

## Instructions for all applications

Fig. A



### 1. CUT OPENING

Use aperture sticker provided as a template to cut hole in the ceiling. Cut to outside edge of sticker. (Fig. A).

Fig. B

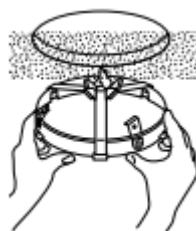

### 2. ATTACH MOUNTING RING

Push MOUNTING RING into opening until FLANGE sits against ceiling making sure J-BOX SLOT is in position that will ensure enough space above ceiling for J-BOX to sit flat against ceiling (Fig. B). Slide MOUNTING STRAPS down to trap ceiling thickness and then bend up to secure (Fig. C).

Fig. C

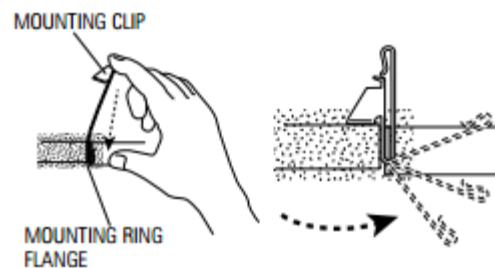

Note: When installing 2003R, Wire-In and push J-BOX through ceiling opening before attaching MOUNTING RING.

## Instructions for all applications

**3. WIRE-IN**

With 1103R and 1003R Remodeler Kits, the J-BOX can be hung temporarily from MOUNTING RING to assist with wire-in. Open hinged J-BOX COVER fully to its locked position (lift slightly to unlock).

Option 1: Remove one of the provided KNOCK OUTS. Insert supplied (or Equivalent) snap in NON-METALLIC CABLE CLAMP into KNOCK OUT. Push cables through single CLAMP.

Note: Snap in supplied CLAMP: Fits NM CABLES #14/2, #14/3, #12/2, #10/2, #10/3,

Option 2: Open hinged KNOCK OUT to allow NON-METALLIC CABLE to enter JUNCTION BOX. Push CABLE through CLAMP.

Note: Wiring and connections must not be placed in JUNCTION BOX in a manner which will interfere with the CLAMPS action to provide strain relief (Fig. D).

Wire to SUPPLY LEADS. WHITE FIXTURE LEAD to NEUTRAL SUPPLY LEAD. BLACK FIXTURE LEAD to HOT (120V) SUPPLY LEAD. BARE FIXTURE WIRE to SUPPLY GROUND. Use wirenuts (local hardware item). Place all electrical connections in the J-BOX and close the J-BOX COVER (Fig. E).

**4. ATTACH J-BOX**

Insert J-BOX MOUNTING STRAP between the ceiling material and MOUNTING RING and through the J-BOX SLOT on the MOUNTING RING. Pull the STRAP until the J-BOX PLATE sits flat on the ceiling with the feet over the edge of the ceiling thickness. Bend J-BOX PLATE MOUNTING STRAP up to secure (Fig. F, G).

Make sure the J-BOX PLATE is securely attached to the ceiling and the J-BOX is in the position shown (Fig. G).

**5. SNAP-ON**

Important - Insert SOCKET CUP in neck of REFLECTOR making sure SPRING TABS fully engage into SLOTS in REFLECTOR (Fig. H).

**6. PUSH-UP**

Push REFLECTOR TRIM straight up until it is tight against ceiling (Fig. I).

Note: See separate reflector trim instruction sheets for step 5 and 6.

**Fig. D**  
Option 1. Example Supplied CLAMP

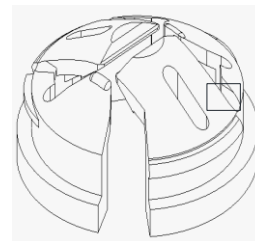

**Fig. E**  
Option 2.

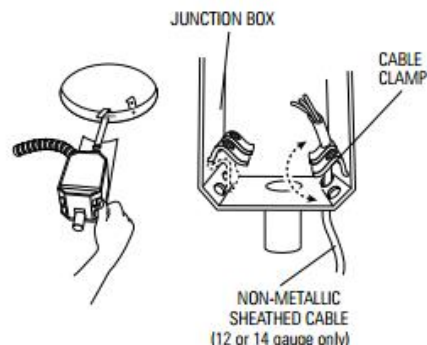

**Fig. F**

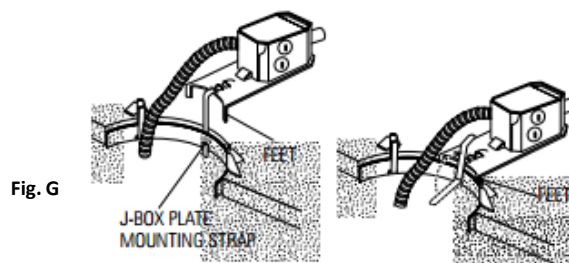

**Fig. G**



**Fig. H**



**Fig. I**

