



## Ordering guide

Example: PTH2350 P3 A

Product Code	Post Diameter	Finish
<b>PTH2350</b>		
PTH2350 Quintuple	<b>P3</b> 3" Post Mount <b>P4</b> 4" Post Mount	<b>A</b> Black <b>B</b> White <b>G</b> Verde <b>H</b> Bronze <b>J</b> Green

Project: \_\_\_\_\_

Location: \_\_\_\_\_

Cat.No: \_\_\_\_\_

Type: \_\_\_\_\_

Lamps: \_\_\_\_\_ Qty: \_\_\_\_\_

Notes: \_\_\_\_\_

## Specifications

### Housing

356 HM high-strength, low-copper, proprietary cast aluminum alloy.

### Finish

Thermoset polyester powdercoat is electrostatically applied after a five-stage conversion cleaning process and bonded by heat fusion thermosetting. Laboratory tested for superior weatherability and fade resistance in accordance with ASTM B117 specifications. For larger projects where a custom color is required, contact the factory for more information.

### Mounting

Cast Aluminum Hub mounts to a 3" OD x 3" long (P3) [if applicable] or 4" OD x 6 1/2" long (P4) [if applicable] tenon and is secured with at least (3) 5/16"-18 stainless steel set screws.

### Warranty

Three-year limited warranty.

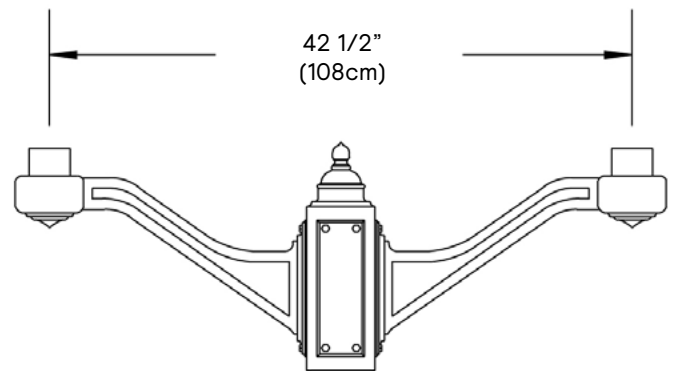

Height	Length	EPA
17" (43 cm)	42 1/2" (108 cm)	2.59 sq. ft.