



by Signify

Mounting Instructions

Island gear tray

NatureConnect

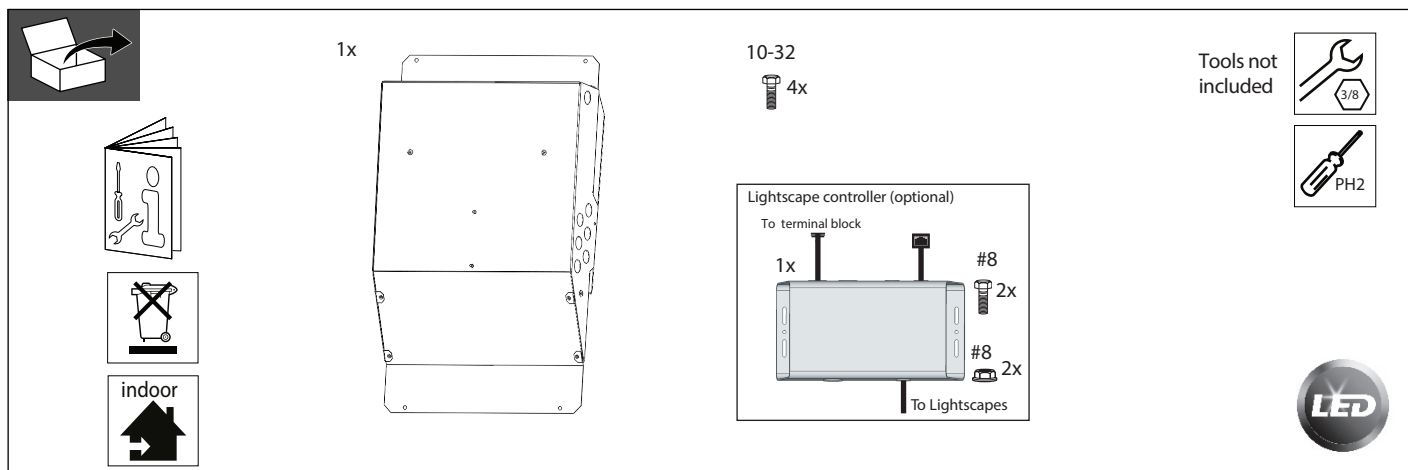

	Dimensions LxWxH	
Island gear tray	367.7x532.7x83.5 mm 14.5x 21 x 3.3 in	3.6 kg 8 lb

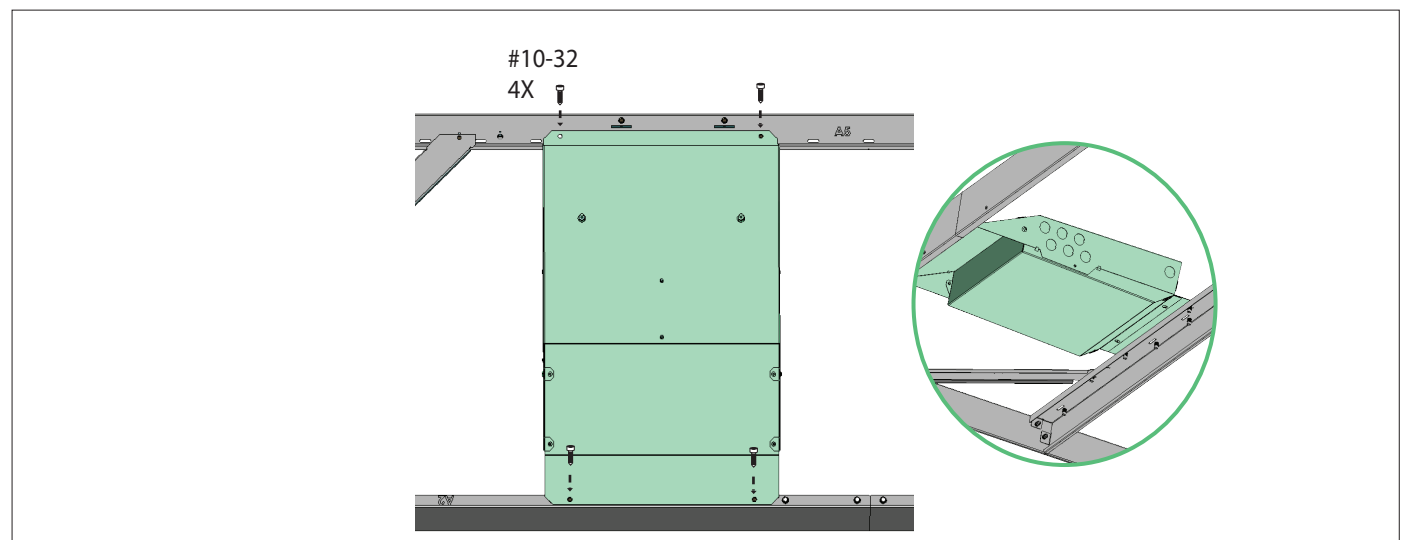
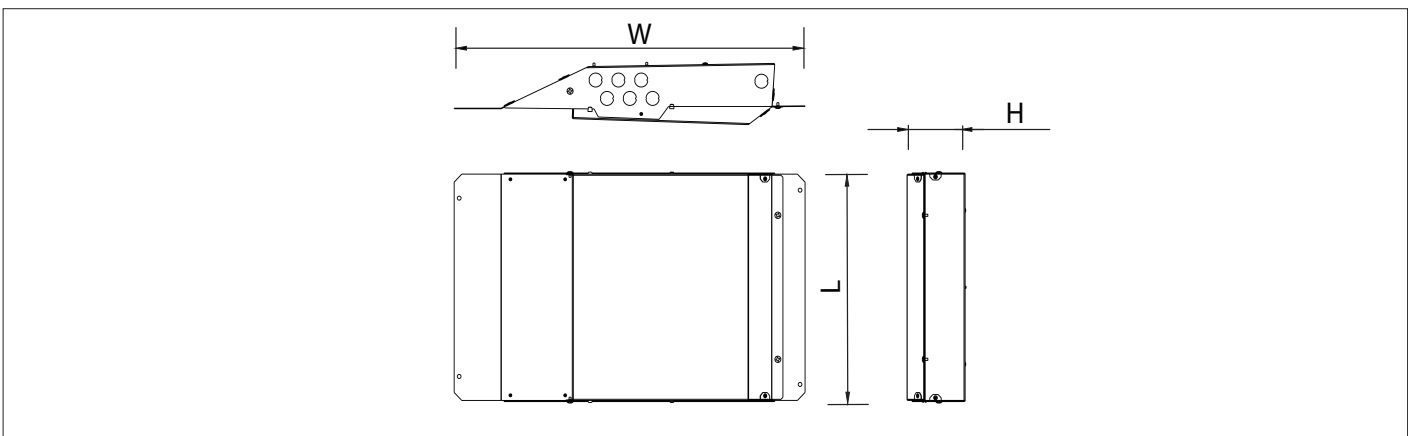

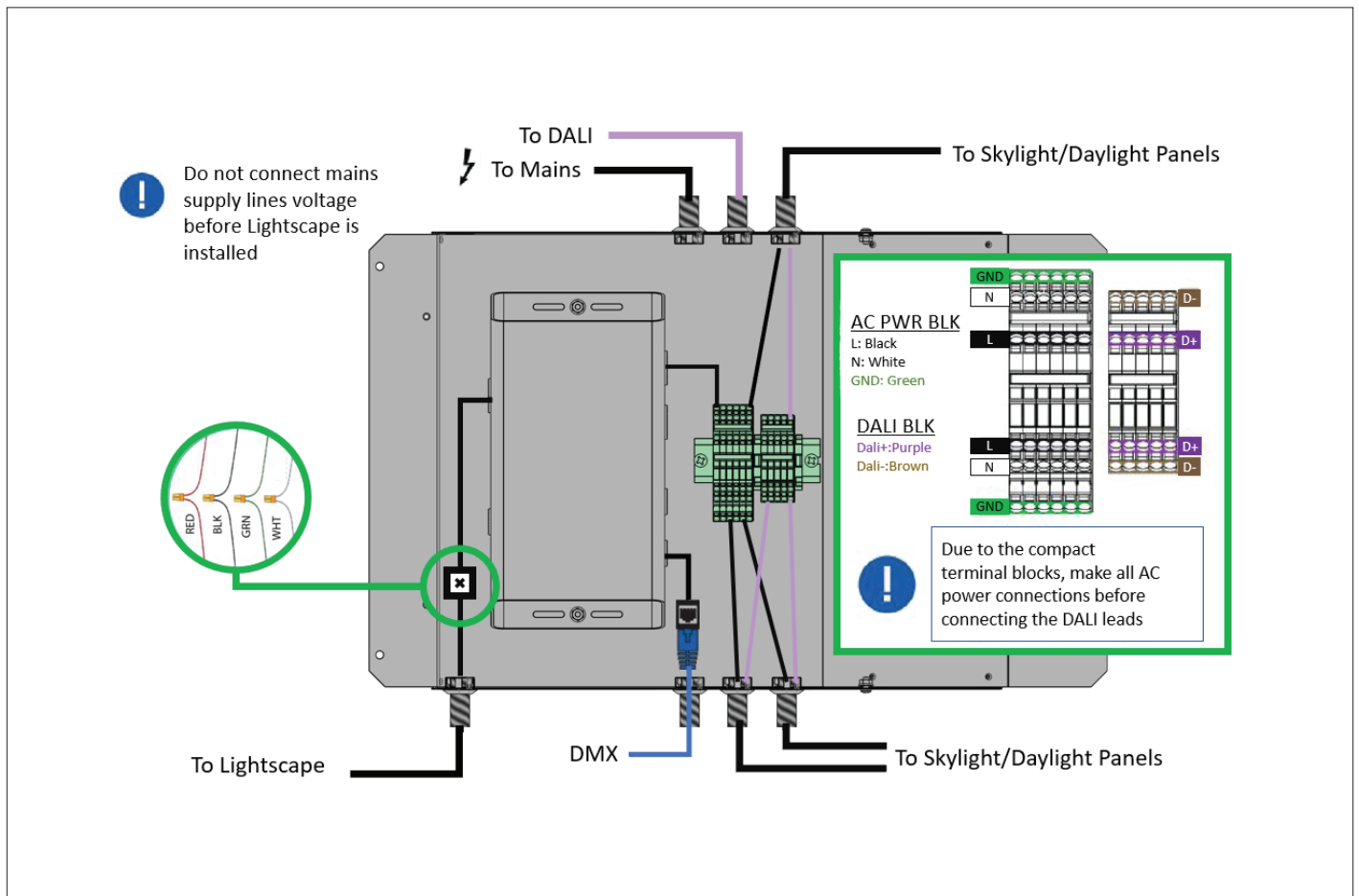

Please, consult your Signify representative for the NatureConnect system installation manual.

ATTENTION
Consult your Signify representative for the NatureConnect system installation manual.

- Gear tray shall be installed by a qualified electrician and wired in accordance with the latest IEE electrical regulations or the national requirements. If the external flexible cable or cord of this luminaire is damaged, it shall be exclusively replaced by the manufacturer, his service agent or similar qualified person in order to avoid hazard.
- The product is IPX0 & as such is not protected against water ingress & as such we strongly recommend that the environment in which the luminaire is to be installed is suitably checked.
- If the above advice is not taken and the products are subject to water ingress, Signify cannot guarantee safe failure & product warranty will become void.

Note: This equipment has been tested and found to comply with the limits for Class A digital device, pursuant to part 15 of the FCC Rules. These limits are designed to provide reasonable protection against harmful interference when the equipment is operated in a commercial environment. This equipment generates, uses, and can radiate radio frequency energy and, if not installed and used in accordance with the instruction manual, may cause harmful interference to radio communications. Operation of this equipment in a residential area is likely to cause harmful interference in which case the user will be required to correct the interference at his own expense.