



Add detail and style to any space with the Vetro accents and Calculite 4" LED downlights.

Complete luminaire = Frame + Trim or Micro Vetro (optional) + Installation Accessories (if required)

Project: _____
 Location: _____
 Cat.No: _____
 Type: _____
 Lamps: _____ Qty: _____
 Notes: _____

Decorative Element

example: D4A01 + C4RDL + 4RN

Series	Model	Use with trim kit*	Use with frame-in kits
D4A Decorative Element - 4" Calculite LED - 4" Calculite CFL	01 Round acrylic with aluminum insert	LED: C4RDL	LED: 4RN
	02 Round acrylic		
	03 Round angled double opal glass		
	04 Round opal glass		

* Trim kit must be ordered separately. All combinations required the appropriate Calculite frame-in kit.

Specify Reflector separately. Flangeless trim required for Decorative element. Use specular clear (CL) finish for best performance.

Features

1. Decorative element:

- (01) Solid high temp, UV resistant composite with open aperture, frosted interior diameter and polished exterior. Satin aluminum ring is mechanically inserted in composite to create drama and intrigue in the element.
- (02) Solid high temp, UV resistant composite with open aperture, frosted interior diameter and polished exterior. Machined facet along bottom edge.
- (03) Angled hand blown triplex glass carefully proportioned to each aperture size. Glass is gently and evenly illuminated for clean brightness recognition.
- (04) Cylindrical hand blown triplex glass carefully proportioned to each aperture size. Glass is gently and evenly illuminated for clean brightness recognition.

- 2. **Die cast construction ring:** Exterior edge of construction ring is visible, satin aluminum finish matches diameter of decorative element for a flangeless appearance. Aluminum die cast finish ring with crisp 90° edges conceals all fasteners for a clean finished appearance.
- 3. **Integral reflector:** 16 ga. aluminum, 50° visual cutoff to lamp and lamp image. Decorative Element is mechanically attached to reflector via die cast ring. Reflector is specular clear for best performance and aesthetics.
- 4. **Reflector:** Specified separately. Flangeless trim required. Use specular clear (CL) finish for best performance and aesthetics.
- 5. **Frame-in kit:** Specified separately. See frame-in kit specification sheet for details.

Mechanical

Decorative element are mechanically secured to the die cast construction ring and the integral reflector from the factory.
 Stamped aluminum cover ring provided on top of decorative element to cover construction ring fasteners.
 Four #8-32 screws and 4 knurled die-cast thumb screws secure construction ring to frame in kit.

Labels

cULus Listed.
 Suitable for damp locations.



D4A Vetrol Accessory

Round decorative elements for Calculite LED 4"

Dimensions



D4A01
Round acrylic
w/aluminum
insert

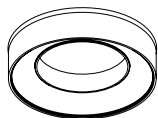

D4A02
Round acrylic

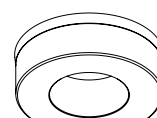

D4A03
Round angled
double opal glass

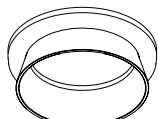

D4A04
Round opal glass

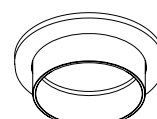

Cat. No.	Size	Aperture	Width	Depth
D4A01	4"	3 ³ / ₄ " (95 mm)	6" (152 mm)	1 ³ / ₄ " (44 mm)
D4A02	4"	3 ¹ / ₂ " (89 mm)	6" (152 mm)	1 ³ / ₄ " (44 mm)
D4A03	4"	5 ¹ / ₈ " (130 mm)	6 ¹ / ₄ " (159 mm)	2" (51 mm)
D4A04	4"	4 ¹ / ₈ " (105 mm)	6 ¹ / ₄ " (159 mm)	2" (51 mm)

The information presented in this document is not intended as any commercial offer and does not form part of any quotation or contract.



© 2019 Signify Holding. All rights reserved. This document contains information relating to the product portfolio of Signify which information may be subject to change. No representation or warranty as to the accuracy or completeness of the information included herein is given and any liability for any action in reliance thereon is disclaimed. All trademarks are owned by Signify Holding or their respective owners.

Signify North America Corporation
200 Franklin Square Drive,
Somerset, NJ 08873
Telephone 855-486-2216

Signify Canada Ltd.
281 Hillmount Road,
Markham, ON, Canada L6C 2S3
Telephone 800-668-9008