

# LUMEC

by ©signify

## Succeed in your roadway lighting design goals

Roadway

RoadView







# Versatile performance

## Innovative solutions

The Lumeec RoadView LED roadway luminaires were created to help those responsible for lighting our streets and highways succeed in their lighting design goals. Powered by the LEDGINE LED platform, and featuring innovative thermal management design, the RoadView offers exceptional performance and value. This versatile luminaire can be tailored to the unique specifications of each project by offering multiple LED boards and wattage options.

## Sustainable performance

Utilizing LEDGINE Platform drivers the RoadView provides exceptional energy efficiency. This luminaire is manufactured with fully recyclable aluminum castings and extrusions that help to protect our environment for years to come. Energy efficiency is enhanced with optional dimming, programmable drivers, and outdoor control systems.



# LEDGINE LED solutions

- ✓ Maximized energy savings
- ✓ Compatible with full range of lighting control systems
- ✓ Easy to maintain on-site
- ✓ Easy to upgrade – to benefit from latest LED technology
- ✓ Best lighting quality and uniformity
- ✓ Designed for roadway lighting applications and standards



## The RoadView incorporates several features that make it a versatile luminaire.

- ✓ Easy to install
- ✓ Easy to maintain
- ✓ Rotatable photocontrol receptacle
- ✓ Accommodates different types of control systems
- ✓ Accommodates 1.25" to 2" arm mounts
- ✓ Adjustable leveling features
- ✓ Surge protection
- ✓ Bird Guard
- ✓ Dimmable Drivers



## Product features

Designed to accommodate the latest in street lighting control technology

Versatile and expandable LED boards

Highly efficient IP66 optics improve illuminance uniformity

Expanded flexibility in choosing the right wattage for the application

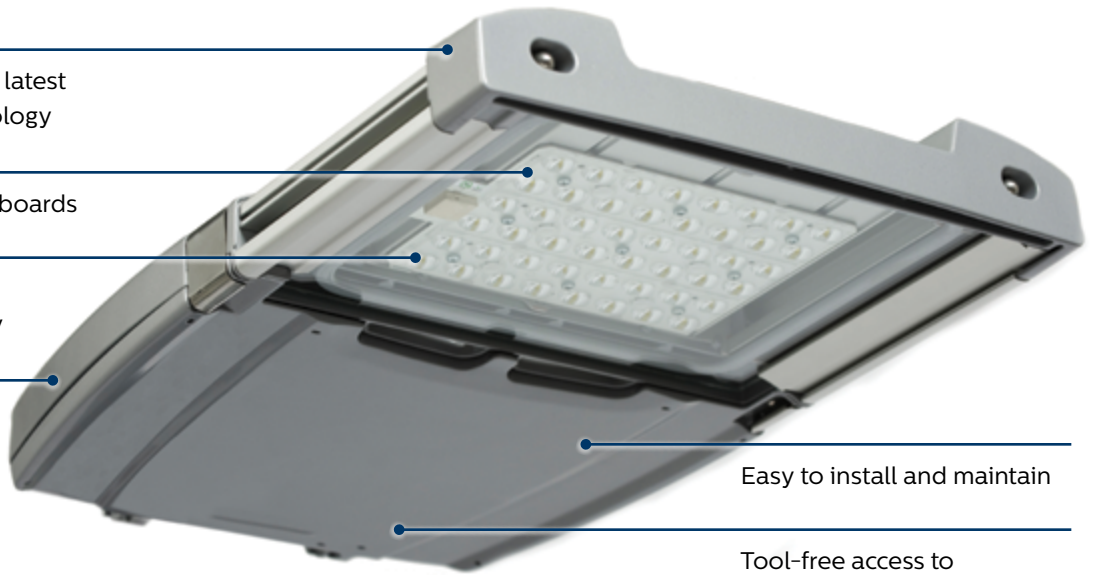

Easy to install and maintain

Tool-free access to electrical compartment



✓ Reversible mounting that accommodates different arm diameters

✓ Innovative thermal management provides longer LED lifetime

✓ 360° rotating twist-lock photocell receptacle

✓ Competitive high value performance luminaire

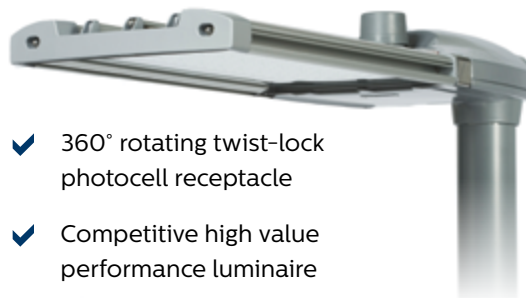

✓ Up to 100,000 hr rated life

✓ 3G tested per ANSI C136.31

✓ Modular design

✓ Protective lens

## Dimensions

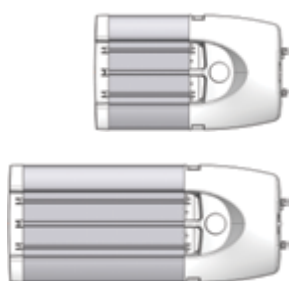

Fixture	Standard wattage	Weight		Length		EPA	
		lb.	kg.	in.	mm.	sq. ft.	sq. m.
RVS	55W32LED	23	10.4	21.38	543	0.53	0.049
	80W48LED	23	10.4	21.38	543	0.53	0.049
	110W64LED	26	11.8	25.25	641	0.60	0.056
	135W80LED	26	11.8	25.25	641	0.60	0.056
RVM	160W96LED	34	15.4	31.25	794	0.71	0.066
	190W112LED	34	15.4	31.25	794	0.71	0.066
	215W128LED	34	15.4	31.25	794	0.71	0.066
	245W144LED	37	16.8	35.25	895	0.78	0.072
	270W160LED	37	16.8	35.25	895	0.78	0.072

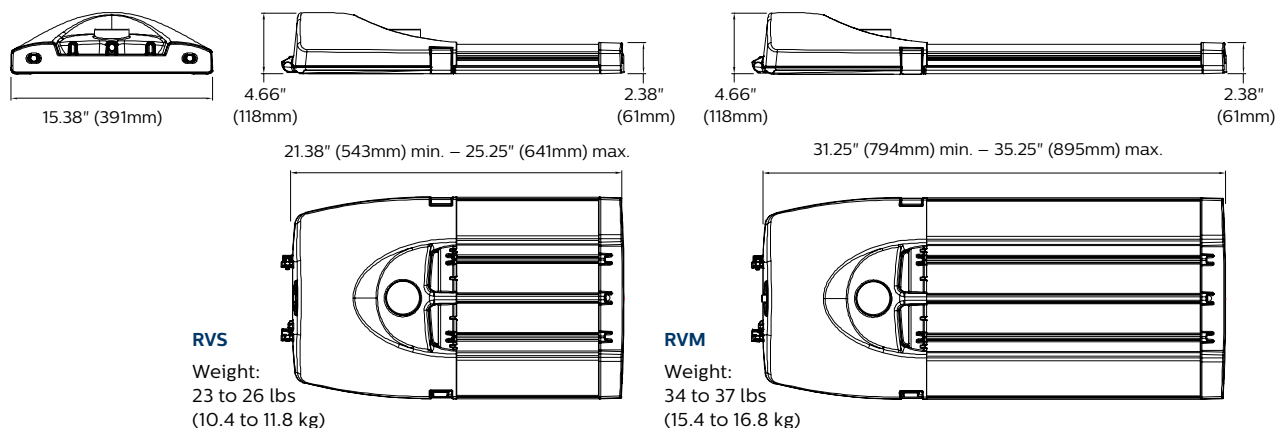

## Energy

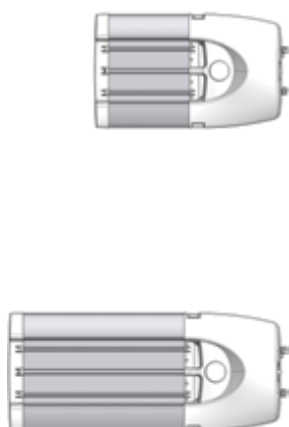

Fixture	Number of LEDs	Lamps	Typical wattage		Max. system current (amps)	LED drive current (mA)
			Lamp	System		
RVS	32	35W32LED4K	35	37	0.31	350
	32	55W32LED4K	55	56	0.47	530
	32	72W32LED4K	72	73	0.61	700
	48	55W48LED4K	55	53	0.44	350
	48	80W48LED4K	80	81	0.68	530
	48	108W48LED4K	108	105	0.88	700
	64	70W64LED4K	70	68	0.57	350
	64	110W64LED4K	110	104	0.87	530
	80	90W80LED4K	90	85	0.71	350
	80	135W80LED4K	135	129	1.08	530
RVM	96	110W96LED4K	110	105	0.88	350
	96	160W96LED4K	160	160	1.33	530
	96	215W96LED4K	215	208	1.73	700
	112	125W112LED4K	125	120	1.00	350
	112	190W112LED4K	190	183	1.53	530
	128	145W128LED4K	145	137	1.14	350
	128	215W128LED4K	215	209	1.74	530
	144	160W144LED4K	160	154	1.28	350
	144	245W144LED4K	245	235	1.96	530
	160	180W160LED4K	180	170	1.42	350
	160	270W160LED4K	270	260	2.17	530

CRI 70 minimum, Nominal ANSI CCT 4000K.





# Maintenance



RoadView incorporates a removable power door



Quick disconnects provided



Power door easily removable for maintenance or upgrade

## Luminaire options

- BL:** Bubble level
- RC:** Receptacle for photocell or shorting cap
- SR:** Strain relief (consult factory)
- HS:** Internal house side shield
- PH8:** Photocell and receptacle
- PH8/347:** Twist lock photoelectric cell
- PH8/480:** Twist lock photoelectric cell
- PHXL:** Extended life photoelectric cell

## Driver options

- CDMG:** Programmable step-dimming
- DMG:** Dimming driver

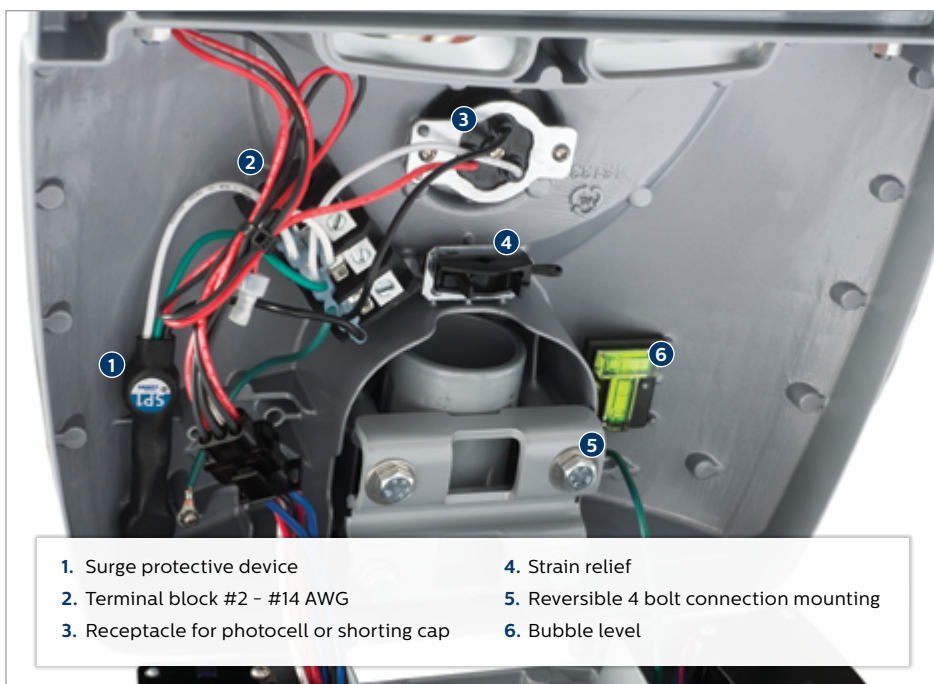

1. Surge protective device
2. Terminal block #2 - #14 AWG
3. Receptacle for photocell or shorting cap
4. Strain relief
5. Reversible 4 bolt connection mounting
6. Bubble level

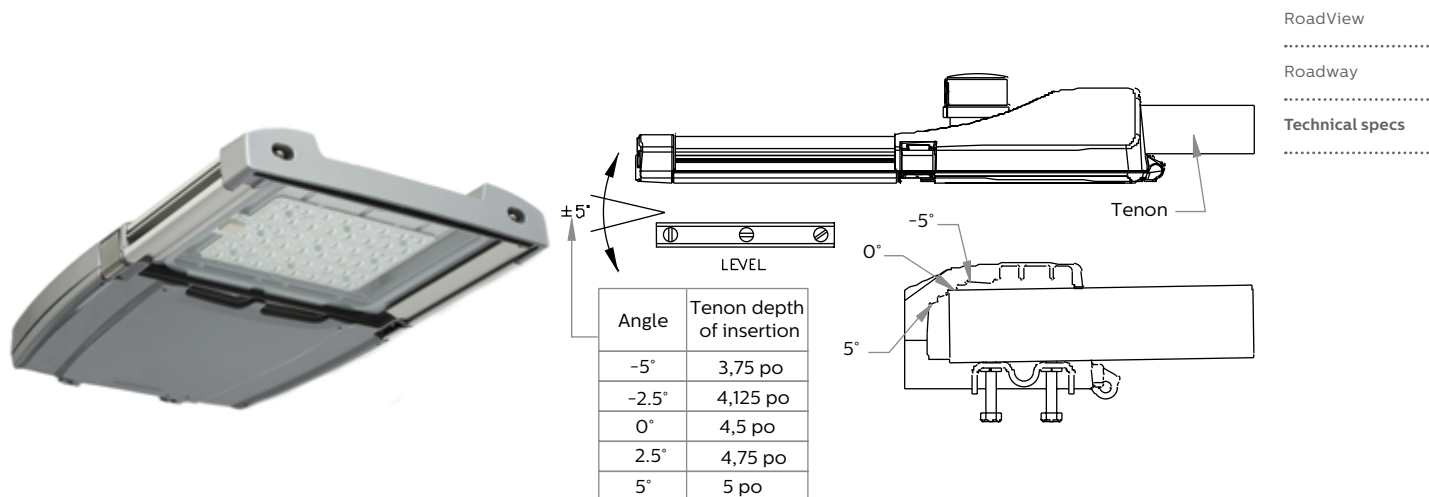

## Ordering guide

Example: RVM-215W96LED4K-G2-LE3-UNV-DMG-GY3

Series	LED module		Gen.	Optics	Voltage	Driver options	Luminaire options	Accessories	Finish
			<div>G2</div>						
RVM	<b>3000K</b>	<b>4000K</b>	G2 Gen2	<b>LE2</b> Type II (ASYM) <b>LE3</b> Type III (ASYM) <b>LE4</b> Type IV (ASYM) <b>LE5<sup>2</sup></b> Type V (ASYM)	<b>HVU</b> 347-480V <b>UNV</b> 120-277V	<b>AST</b> Pre-set driver for progressive start-up <b>CDMGE25</b> 8 hrs. 25% reduction <b>CDMGE50</b> 8 hrs. 50% reduction <b>CDMGE75</b> 8 hrs. 75% reduction <b>CDMGM25</b> 6 hrs. 25% reduction <b>CDMGM50</b> 6 hrs. 50% reduction <b>CDMGM75</b> 6 hrs. 75% reduction <b>CDMGS25</b> 4 hrs. 25% reduction <b>CDMGS50</b> 4 hrs. 50% reduction <b>CDMGS75</b> 4 hrs. 75% reduction <b>CLO</b> Pre-set driver to manage lumen depreciation <b>DMG</b> 0-10V <b>OTL</b> Pre-set driver to signal end of life of the lamp	<b>API</b> Factory Installed NEMA label, ANSI C136.15 compliant <b>BL</b> Bubble Level <b>HS</b> House Side Shield, shield, 1 per 16 LED light engine <b>RC</b> Receptacle for twist-lock photocell or shorting cap, 3-pin <b>SP2</b> 20kV / 20kA Surge Protector (optional)	<b>PH8</b> Twist-lock Photoelectric Cell, UNV (120-277VAC) <b>PH8/347</b> Twist-lock Photoelectric Cell, (347VAC) <b>PH8/480</b> Twist-lock Photoelectric Cell, (480VAC) <b>PHXL</b> Twist-lock Photoelectric Cell, extended life, UNV (120-277VAC) <b>PH9</b> Shorting cap	<b>BK</b> Black <b>BR</b> Bronze <b>GY3</b> Medium Grey <b>WH</b> White
	110W96LED3K	110W96LED4K							
	125W112LED3K	125W112LED4K							
	145W128LED3K	145W128LED4K							
	160W144LED3K	160W144LED4K							
	160W96LED3K	160W96LED4K							
	180W160LED3K	180W160LED4K							
	190W112LED3K	190W112LED4K							
	215W96LED3K	215W96LED4K							
	215W128LED3K	215W128LED4K							
	245W144LED3K	245W144LED4K							
	270W160LED3K	270W160LED4K							
RVS	<b>3000K</b>	<b>4000K</b>							
	35W32LED3K	35W32LED4K							
	55W32LED3K	55W32LED4K							
	55W48LED3K	55W48LED4K							
	70W64LED3K	70W64LED4K							
	72W32LED3K	72W32LED4K							
	80W48LED3K	80W48LED4K							
	90W80LED3K	90W80LED4K							
	108W48LED3K	108W48LED4K							
	110W64LED3K	110W64LED4K							
	135W80LED3K	135W80LED4K							

# Find out more

See how **Lumec RoadView LED** roadway luminaires can help you succeed in your roadway lighting design goals. Contact your local Sales Representative or visit **[signify.com/prolighting](https://signify.com/prolighting)** for more information or to schedule a personalized demonstration.

*Prior to ordering, consult specification sheets for the most current information, notes, and exclusions.*

