

Day-Brite CFI

by  Signify



Special Application

LPL LED series
low profile linear

Vandal resistant 2080, 2200,
2800, 3200, or 3500 lumens



Project: _____
 Location: _____
 Cat.No: _____
 Type: _____
 Lamps: _____ Qty: _____
 Notes: _____

Day-Brite / CFI LPL LED series low profile linear features a marine grade extruded aluminum backplate with die-cast aluminum round or square end caps. Its heavy duty construction is designed to meet the demands of extreme environments.

Ordering guide

Example: **LPLS4L53-35K-UNV-F1**

Family	Ends	LED Input Wattage	Color Temperature	Voltage	Fasteners	Options
LPL Low Profile Linear (2 or 4 ft.)	S Square R Round	2L30 30W LED, 2ft. (2080 lm.) 4L30 30W LED, 4ft.(2200 lm.) 4L38 38W LED, 4ft. (2800 lm.) 4L45 45W LED, 4ft. (3200 lm.) 4L53 53W LED, 4ft.(3500 lm.)	35K 3500K 40K 4000K	UNV Universal voltage, 120-277V	F1 Allen Head Center Pin Reject F2 TORX Head Center Pin Reject	GLR Fusing, fast blow AG Agion™ antimicrobial protection in powder coat paint (white finish only) NSF NSF Listed BK Black finish BZ Bronze finish CS Custom color (provide RAL#) XTR Natatorium environment

General Notes

• Many luminaire components, such as reflectors, refractors, lenses, sockets, lampholders, and LEDs are made from various types of plastics which can be adversely affected by airborne contaminants. If sulfur based chemicals, petroleum based products, cleaning solutions, or other contaminants are expected in the intended area of use, consult factory for compatibility.



LPLS/LPLR LPL LED series low profile linear

Vandal resistant, 2080, 2200, 2800, 3200, or 3500 lumens

Standards

- ETL Listed (US/Canada).
- Wet location, 200 PSI Spray Down Listed.
- ADA Compliant.
- NSF National Sanitation Foundation Approved, Food Zone/Non-Contact and Splash Zone, with NSF option.
- Suitable for Natatorium environments with XTR option.

Construction/Finish

- Marine grade extruded aluminum backplate with die cast square or round aluminum end caps.
- Stainless steel center pin reject Allen Head standard with TORX available.
- Multi-stage pretreatment process, standard finishes are baked white polyester powder coating. Gloss 85%, reflectance 90%, salt spray 1,000 hrs.
- Custom colors available; consult factory.

Lens

- Clear .156" positive interlocking, lighting grade, UV stabilized, extruded high impact polycarbonate lens with .020" white opal acrylic overlay.
- Lens sealed to the housing ends with EPDM sponge rubber cord and closed cell neoprene gasketing.

LEDs

- Philips LED platform technology with high efficiency LEDs in multiple lumen packages; 3500K or 4000K and 80+CRI.
- LEDs have a minimum 50,000 hour rated life (L70).
- Luminaire efficacy up to 80 lumens per Watt depending on input of current. Tested in accordance with LM-79.

Electrical

- Standard Class 2 Compliant electronic LED driver.
- Dimming and Step Dimming options available. Consult factory.

Installation

- Unit may be wall or ceiling mounted individually.

Option

- Agion® antimicrobial protection using silver technology inhibits bacterial colonization on metal interior or exterior surfaces. Agion® antimicrobial protection is FDA recognized and EPA registered meeting all applicable EPA standards.

Dimensions

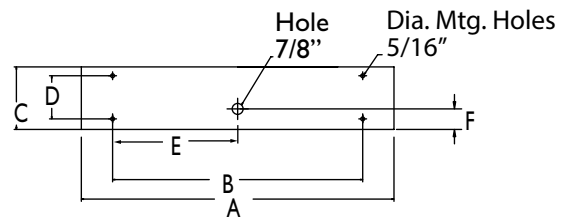
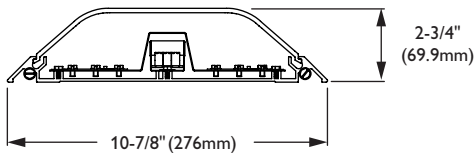

	EndCap	Length	A	B	C	D	E	F
LPL	Square	24"	27.625"	23"	10.875"	7.75"	11.5"	4.5"
LPL	Square	48"	51.625"	47"	10.875"	7.75"	23.5"	4.5"
LPL	Round	24"	32"	23"	10.875"	7.75"	11.5"	4.5"
LPL	Round	48"	56"	47"	10.875"	7.75"	23.5"	4.5"

LPLS/LPLR LPL LED series low profile linear

Vandal resistant, 2080, 2200, 2800, 3200, or 3500 lumens

Photometry

4' Low Profile LPL LED Series

LER – 74

Catalog No.	LPL4L30-UNV	Candlepower				Light Distribution			Average Luminance			
		Angle	End	45	Cross	Degrees	Lumens	% Luminaire	Angle	End	45'	Cross
Test No.	29618	0	646	646	646	0-30	506	22.7	45	2433	2248	2263
S/MH	1.4	5	648	645	637	0-40	832	37.3	55	2271	2111	2221
Lamp Type	30WLED	15	626	624	620	0-60	1498	67.2	65	2000	1994	2212
Lumens/Lamp	2232	25	578	584	586	0-90	2087	93.6	75	1553	1882	2213
Input Watts	30	35	510	523	531	0-180	2230	100.0	85	808	1886	2361
		45	424	446	463	Coefficients of Utilization						
		55	326	362	397	EFFECTIVE FLOOR CAVITY REFLECTANCE 20 PER (pfc=0.20)						
		65	217	194	247	pcc						
		75	109	194	247	80						
		85	24	120	171	70						
		95	0	74	121	50						
		105	0	39	78	pw						
		115	1	16	47	70 50 30						
		125	1	2	17	RCR						
		135	1	1	2	0						
		145	1	1	1	1						
		155	1	1	1	2						
		165	3	3	3	3						
		175	3	2	2	4						
						5						
						6						
						7						
						8						
						9						
						10						

2' Low Profile LPL LED Series

LER – 67

Catalog No.	LPL2L30	Candlepower				Light Distribution			Average Luminance			
		Angle	End	45	Cross	Degrees	Lumens	% Luminaire	Angle	End	45'	Cross
Test No.	30400	0	625	625	625	0-30	486	23.3	45	4615	4310	4507
S/MH	1.3	5	621	621	626	0-40	796	38.2	55	4233	3988	4340
Lamp Type	30WLED	15	597	599	605	0-60	1424	68.4	65	3738	3716	4156
Lumens/Lamp	2081	25	549	556	563	0-90	1963	94.3	75	2834	3351	3990
Input Watts	31W	35	484	494	507	0-180	2081	100.0	85	1429	3081	4042
		45	400	419	441	Coefficients of Utilization						
		55	307	338	371	EFFECTIVE FLOOR CAVITY REFLECTANCE 20 PER (pfc=0.20)						
		65	210	259	293	pcc						
		75	108	176	213	80						
		85	27	104	140	70						
		95	1	60	95	50						
		105	0	34	64	pw						
		115	0	13	36	70 50 30						
		125	1	2	13	RCR						
		135	1	1	1	0						
		145	1	1	1	1						
		155	1	1	1	2						
		165	1	1	1	3						
		175	1	1	1	4						
						5						
						6						
						7						
						8						
						9						
						10						

additional photometry

Test #	Wattage
29615	38WLED
29611	45WLED
29555	53WLED

