



Alkco's LPL LED series is a low profile linear product that features a marine grade extruded aluminum backplate with die-cast aluminum round or square end caps. The heavy duty construction is designed to meet the demands of your healthcare space.

Project: _____
 Location: _____
 Cat.No: _____
 Type: _____
 Lamps: _____ Qty: _____
 Notes: _____

Ordering guide

Example: **LPLS4L53-35K-UNV-F1**

Family	Ends	LED Input Wattage	Color Temperature	Voltage	Fasteners	Options
LPL Low Profile Linear (2 or 4 ft.)	S Square R Round	2L30 30W LED, 2ft. (2080 lm.) 4L30 30W LED, 4ft.(2200 lm.) 4L38 38W LED, 4ft. (2800 lm.) 4L45 45W LED, 4ft. (3200 lm.) 4L53 53W LED, 4ft.(3500 lm.)	35K 3500K 40K 4000K	UNV Universal voltage, 120-277V	F1 Allen Head Center Pin Reject F2 TORX Head Center Pin Reject	GLR Fusing, fast blow AG Agion™ antimicrobial protection in powder coat paint (white finish only) NSF NSF Listed BK Black finish BZ Bronze finish CS Custom color (provide RAL#) XTR Natatorium environment

General Notes

• Many luminaire components, such as reflectors, refractors, lenses, sockets, lampholders, and LEDs are made from various types of plastics which can be adversely affected by airborne contaminants. If sulfur based chemicals, petroleum based products, cleaning solutions, or other contaminants are expected in the intended area of use, consult factory for compatibility.



LPLS/LPLR LPL LED series low profile linear

Vandal resistant, 2080, 2200, 2800, 3200, or 3500 lumens

Standards

- ETL Listed (US/Canada).
- Wet location, 200 PSI Spray Down Listed.
- ADA Compliant.
- NSF National Sanitation Foundation Approved, Food Zone/Non-Contact and Splash Zone, with NSF option.
- Suitable for Natatorium environments with XTR option.

Construction/Finish

- Marine grade extruded aluminum backplate with die cast square or round aluminum end caps.
- Stainless steel center pin reject Allen Head standard with TORX available.
- Multi-stage pretreatment process, standard finishes are baked white polyester powder coating. Gloss 85%, reflectance 90%, salt spray 1,000 hrs.
- Custom colors available; consult factory.

Lens

- Clear .156" positive interlocking, lighting grade, UV stabilized, extruded high impact polycarbonate lens with .020" white opal acrylic overlay.
- Lens sealed to the housing ends with EPDM sponge rubber cord and closed cell neoprene gasketing.

LEDs

- Philips LED platform technology with high efficiency LEDs in multiple lumen packages; 3500K or 4000K and 80+CRI.
- LEDs have a minimum 50,000 hour rated life (L70).
- Luminaire efficacy up to 80 lumens per Watt depending on input of current. Tested in accordance with LM-79.

Electrical

- Standard Class 2 Compliant electronic LED driver.
- Dimming and Step Dimming options available. Consult factory.

Installation

- Unit may be wall or ceiling mounted individually.

Option

- Agion® antimicrobial protection using silver technology inhibits bacterial colonization on metal interior or exterior surfaces. Agion® antimicrobial protection is FDA recognized and EPA registered meeting all applicable EPA standards.

Dimensions

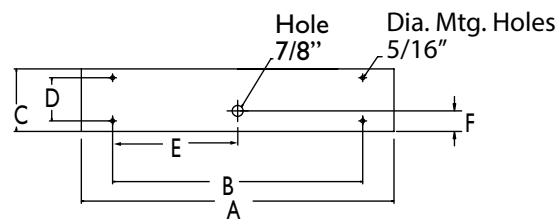
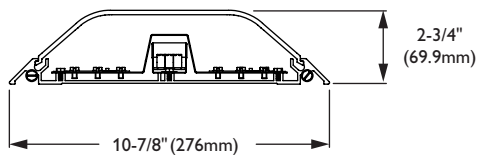

	EndCap Length	A	B	C	D	E	F
LPL	Square	24"	27.625"	23"	10.875"	7.75"	11.5" 4.5"
LPL	Square	48"	51.625"	47"	10.875"	7.75"	23.5" 4.5"
LPL	Round	24"	32"	23"	10.875"	7.75"	11.5" 4.5"
LPL	Round	48"	56"	47"	10.875"	7.75"	23.5" 4.5"

LPLS/LPLR LPL LED series low profile linear

Vandal resistant, 2080, 2200, 2800, 3200, or 3500 lumens

Photometry

4' Low Profile LPL LED Series

LER - 74

Catalog No.		Candlepower				Light Distribution			Average Luminance						
Test No.	S/MH	Lamp Type	Lumens/Lamp	Input Watts	Angle	End	45	Cross	Degrees	Lumens	% Luminaire	Angle	End	45°	Cross
LPL4L30-UNV	29618	1.4	30WLED	2232	30	0	646	646	0-30	506	22.7	45	2433	2248	2263
						5	648	645	0-40	832	37.3	55	2271	2111	2221
						15	626	624	0-60	1498	67.2	65	2000	1994	2212
						25	578	584	0-90	2087	93.6	75	1553	1882	2213
						35	510	523	0-180	2230	100.0	85	808	1886	2361
						45	424	446							
						55	326	362							
						65	217	278							
						75	109	194							
						85	24	120							
						95	0	74							
						105	0	39							
						115	1	16							
						125	1	2							
						135	1	1							
						145	1	1							
						155	1	1							
						165	3	3							
						175	3	2							
						Comparative yearly lighting energy cost per 1000 lumens - \$3.24 based on 3000 hrs. and \$.08 pwr KWH.									
						The photometric results were obtained in the Day-Brite laboratory which is NVLAP accredited by the National Institute of Standards and Technology.									
						Photometric values based on test performed in compliance with LM-79.									

2' Low Profile LPL LED Series

LER - 67

Catalog No.		Candlepower				Light Distribution			Average Luminance						
Test No.	S/MH	Lamp Type	Lumens/Lamp	Input Watts	Angle	End	45	Cross	Degrees	Lumens	% Luminaire	Angle	End	45°	Cross
LPL2L30	30400	1.3	30WLED	2081	31W	0	625	625	0-30	486	23.3	45	4615	4310	4507
						5	621	621	0-40	796	38.2	55	4233	3988	4340
						15	597	599	0-60	1424	68.4	65	3738	3716	4156
						25	549	556	0-90	1963	94.3	75	2834	3351	3990
						35	484	494	0-180	2081	100.0	85	1429	3081	4042
						45	400	419							
						55	307	338							
						65	210	259							
						75	108	176							
						85	27	104							
						95	1	60							
						105	0	34							
						115	0	13							
						125	1	2							
						135	1	1							
						145	1	1							
						155	1	1							
						165	1	1							
						175	1	1							
						Comparative yearly lighting energy cost per 1000 lumens - \$3.58 based on 3000 hrs. and \$.08 pwr KWH.									
						The photometric results were obtained in the Day-Brite laboratory which is NVLAP accredited by the National Institute of Standards and Technology.									
						Photometric values based on test performed in compliance with LM-79.									

additional photometry

Test #	Wattage
29615	38WLED
29611	45WLED
29555	53WLED

