

SHORT REACH BRACKETS

Short reach brackets

RSAR Standard features include:

- Made of cast A356 aluminum, mechanically assembled to the pole.
- Available for a 4" (102mm) to 4.9" (124mm) or 5" (127mm) to 6" (152mm) round or 4" (102mm) minimum square pole. Pole shape and size must be specified when ordered.
- Available with RoadStar only.

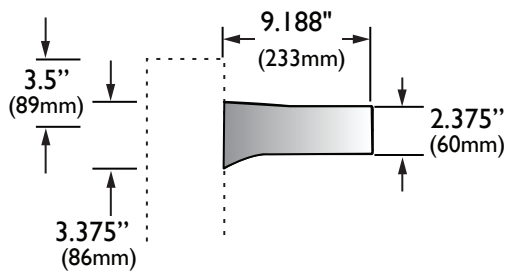

PSA Standard features include:

- Made of cast A356 aluminum, mechanically assembled to the pole.
- Slip-fits a 2.375" (60mm), 3" (76mm) or 4" (102mm) pole. Pole shape and size must be specified when ordered.
- Available with RoadStar only

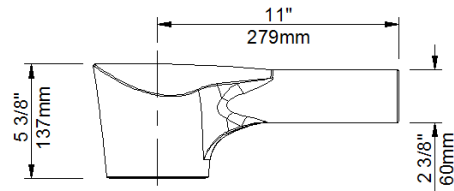

RLAR Standard features include:

- Made of cast A356 aluminum, mechanically assembled to the pole.
- Available for a 4" (102mm) to 4.9" (124mm) or 5" (127mm) to 6" (152mm) round or 4" (102mm) minimum square pole. Pole shape and size must be specified when ordered.
- Available with Helios, RoadView, RX series, MiniView, RoadFocus and StreetView.

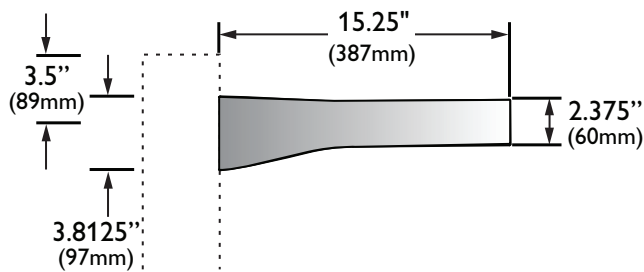

Catalog Number	EPA (square feet)	Weight (pounds)
RSAR	0.19	2.0
RLAR	0.25	3.0
PSA	0.13	3.0

- Consult Factory to validate compatibility with your pole and fixture combination and installation instructions.